



MIRATOHET
KRYETARI I BASHKISË
Z. TONIN MARINAJ

BASHKIA MALESI E MADHE
PROJEKT ZBATIMI

Sistemim asfaltim rruga Syri I Gjonit

- 1– Hoorografia
- 2– Topografia e rruges
- 3– Planimetria e rruges
- 4– Profili gjatësor
- 5– Profilat tërthore
- 6– Profili tërthore tip

PROJEKTOI:
"LENI-ING" SH.P.K

TIRANË 2023



MBARIMI I
RRUGES

FILLIMI I
RRUGES

Porositi :
BASHKIA
MALESI E
MADHE

Projektoi:
"LENI-ING" sh.p.k
Liçense: N.2969
ADMINISTRATOR Nikoll PALUCA
Adresa: Rr. Uran Pano, Pallati 12 kat, Kati 2
Mobile: 0682042270
Email: leni-ing@hotmail.com

Objekti: Sistemim asfaltim rruga Syri I Gjonit		
Faza: Projekt – Zbatim		
Emërtimi i Fletës:	Shkalla:	Tiranë 2023
HOOROGRAFIA E RRUGES	Sh 1:2000	HORO



MIRATOHET
KRYETARI I BASHKISË
Z. TONIN MARINAJ

BASHKIA MALESI E MADHE
PROJEKT ZBATIMI

Sistemim asfaltim rruga Syri I Gjonit

- 1– Hoorografia
- 2– Topografia e rruges
- 3– Planimetria e rruges
- 4– Profili gjatësor
- 5– Profilat tërthore
- 6– Profili tërthore tip

PROJEKTOI:
"LENI-ING" SH.P.K

TIRANË 2023

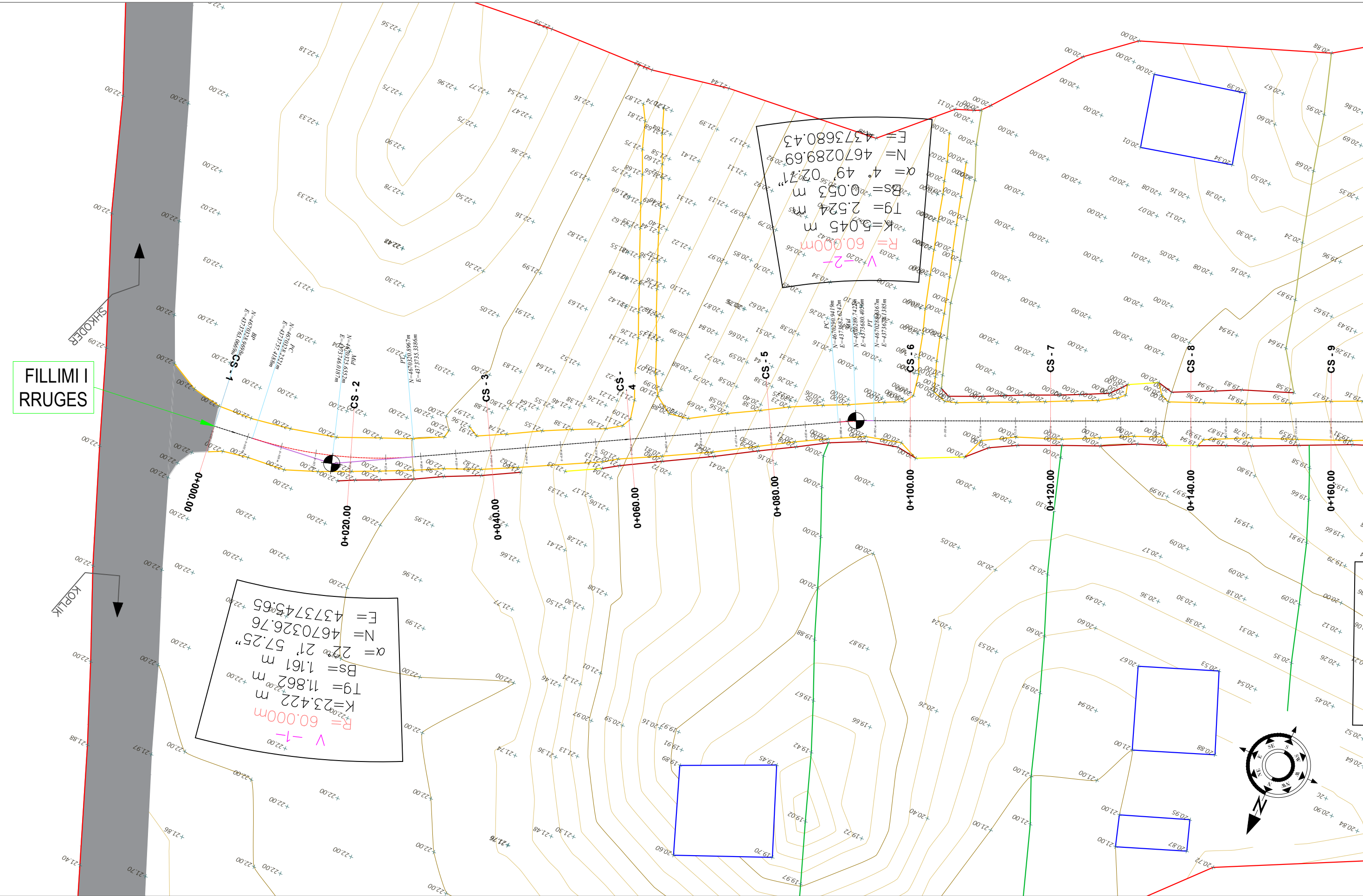

FILLIMI I RRUGES

$R = 60.000m$
 $K = 23.422m$
 $T_9 = 11.862m$
 $B_s = 1.161m$
 $\alpha = 27^\circ 57.25''$
 $N = 4670326.76$
 $E = 4373743.65$

$R = 60.000m$
 $K = 5.045m$
 $T_9 = 2.524m$
 $B_s = 0.053m$
 $\alpha = 4^\circ 49.0271''$
 $N = 4670289.69$
 $E = 4373680.43$

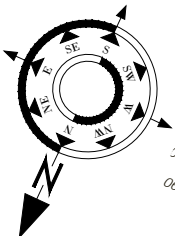

SHPJEGUES

- 156.95 Pike detaje
- 158.0 Izohipse
- Objekt
- Kanal Natyral
- Rrethim
- Mur Rrethues

Porositi :
 BASHKIA
 MALESI E
 MADHE

Projektoi:
 "LENI-ING" sh.p.k
 Liçense: N.2969
 ADMINISTRATOR Nikoll PALUCA
 Adresa: Rr. Uran Pano, Pallati 12 kat, Kati 2
 Mobile: 0682042270
 Email: leni-ing@hotmail.com

Objekti: Sistemim asfaltim rruga Syri I Gjonit		
Faza: Projekt – Zbatim		
Emërtimi i Fletës: TOPOGRAFIA E RRUGES	Shkalla: Sh 1:500	Tiranë 2023 Topo

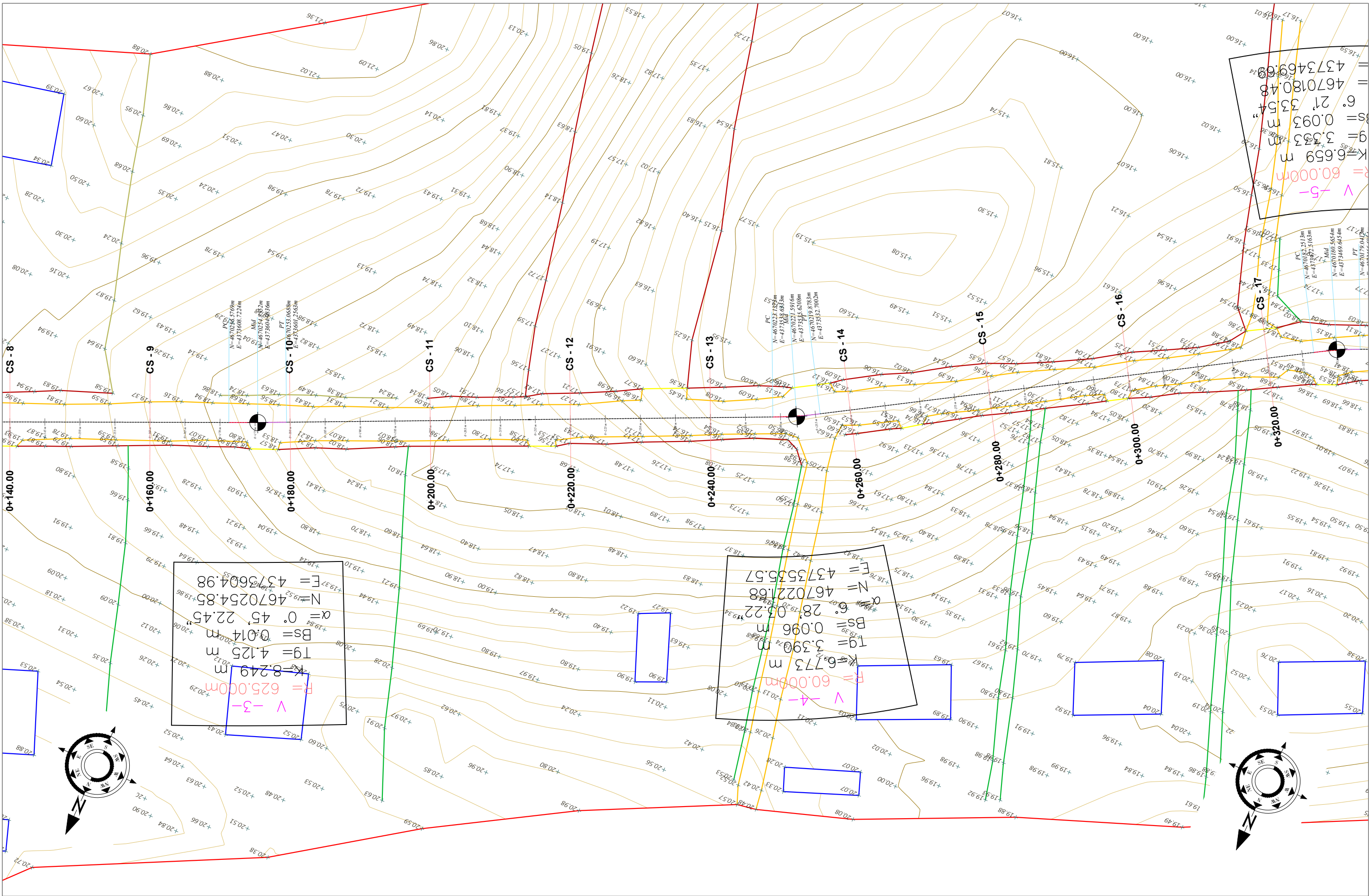

$R = 625.00\text{m}$
 $K = 8.249\text{m}$
 $Tg = 4.125\text{m}$
 $Bs = 0.014\text{m}$
 $\alpha = 0.45$
 22.45
 $N = 4670254.85$
 $E = 4373604.98$

$R = 60.00\text{m}$
 $K = 6.773\text{m}$
 $Tg = 3.390\text{m}$
 $Bs = 0.096\text{m}$
 6.28
 0.522
 $N = 4670221.08$
 $E = 4373555.57$

$R = 60.00\text{m}$
 $K = 6.659\text{m}$
 $Tg = 3.333\text{m}$
 $Bs = 0.093\text{m}$
 6.21
 33.54
 $N = 4670180.48$
 $E = 4373469.68$

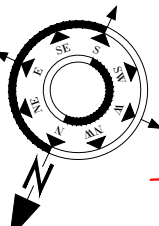

SHPJEGUES

- 156.95 Pike detaje
- 158.0 Izohipse
- Objekt
- Kanal Natyral
- Rrethim
- Mur Rrethues

Porositi :
 BASHKIA
 MALESI E
 MADHE

Projektoi:
 "LENI-ING" sh.p.k
 Liçense: N.2969
 ADMINISTRATOR Nikoll PALUCA
 Adresa: Rr. Uran Pano, Pallati 12 kat, Kati 2
 Mobile: 0682042270
 Email: leni-ing@hotmail.com

Objekti: Sistemim asfaltim rruga Syri I Gjonit		
Faza: Projekt – Zbatim		
Emërtimi i Fletës: TOPOGRAFIA E RRUGES	Shkalla: Sh 1:500	Tiranë 2023 Topo (2)

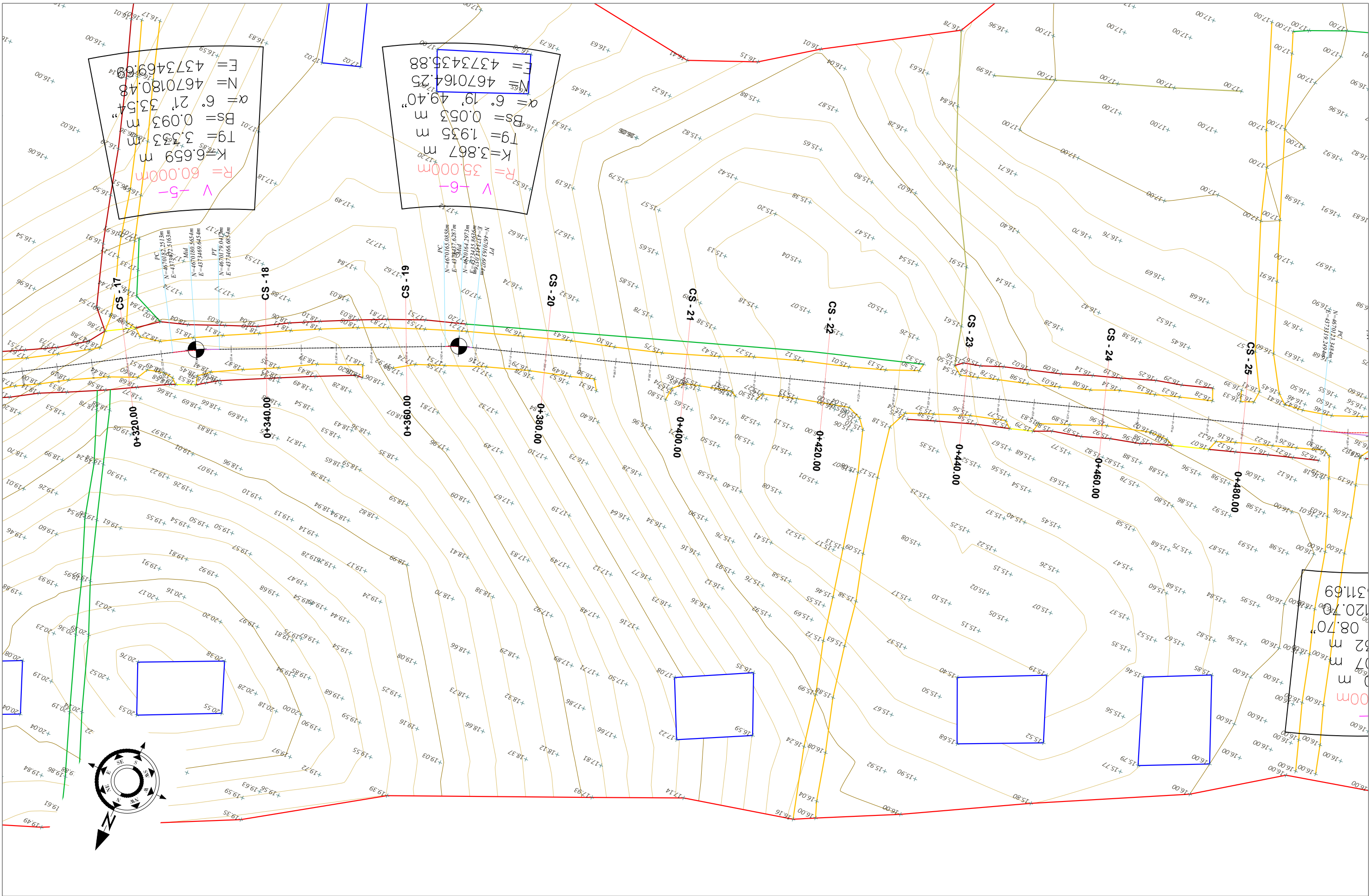

$R = 60.000\text{m}$
 $K = 6.659\text{m}$
 $Tg = 3.523\text{m}$
 $Bs = 0.093\text{m}$
 $\alpha = 6^\circ 21' 33.54''$
 $N = 4670180.48$
 $E = 4373469.89$

$R = 35.000\text{m}$
 $K = 3.867\text{m}$
 $Tg = 1.935\text{m}$
 $Bs = 0.053\text{m}$
 $\alpha = 6^\circ 19' 49.40''$
 $N = 4670164.25$
 $E = 4373435.88$

00m
 07 m
 32 m
 08.70"
 120.70
 311.69

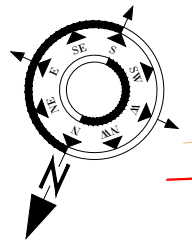

SHPJEGUES

- 156.95 Pike detaje
- 158.0 Izohipse
- Objekt
- Kanal Natyral
- Rrethim
- Mur Rrethues

Porositi :
 BASHKIA
 MALESI E
 MADHE

Projektoi:
 "LENI-ING" sh.p.k
 Liçense: N.2969
 ADMINISTRATOR Nikoll PALUCA
 Adresa: Rr. Uran Pano, Pallati 12 kat, Kati 2
 Mobile: 0682042270
 Email: leni-ing@hotmail.com

Objekti: Sistemim asfaltim rruga Syri I Gjonit		
Faza:		Projekt – Zbatim
Emërtimi i Fletës:	Shkalla:	Tiranë 2023
TOPOGRAFIJA E RRUGES	Sh 1:500	Topo (3)

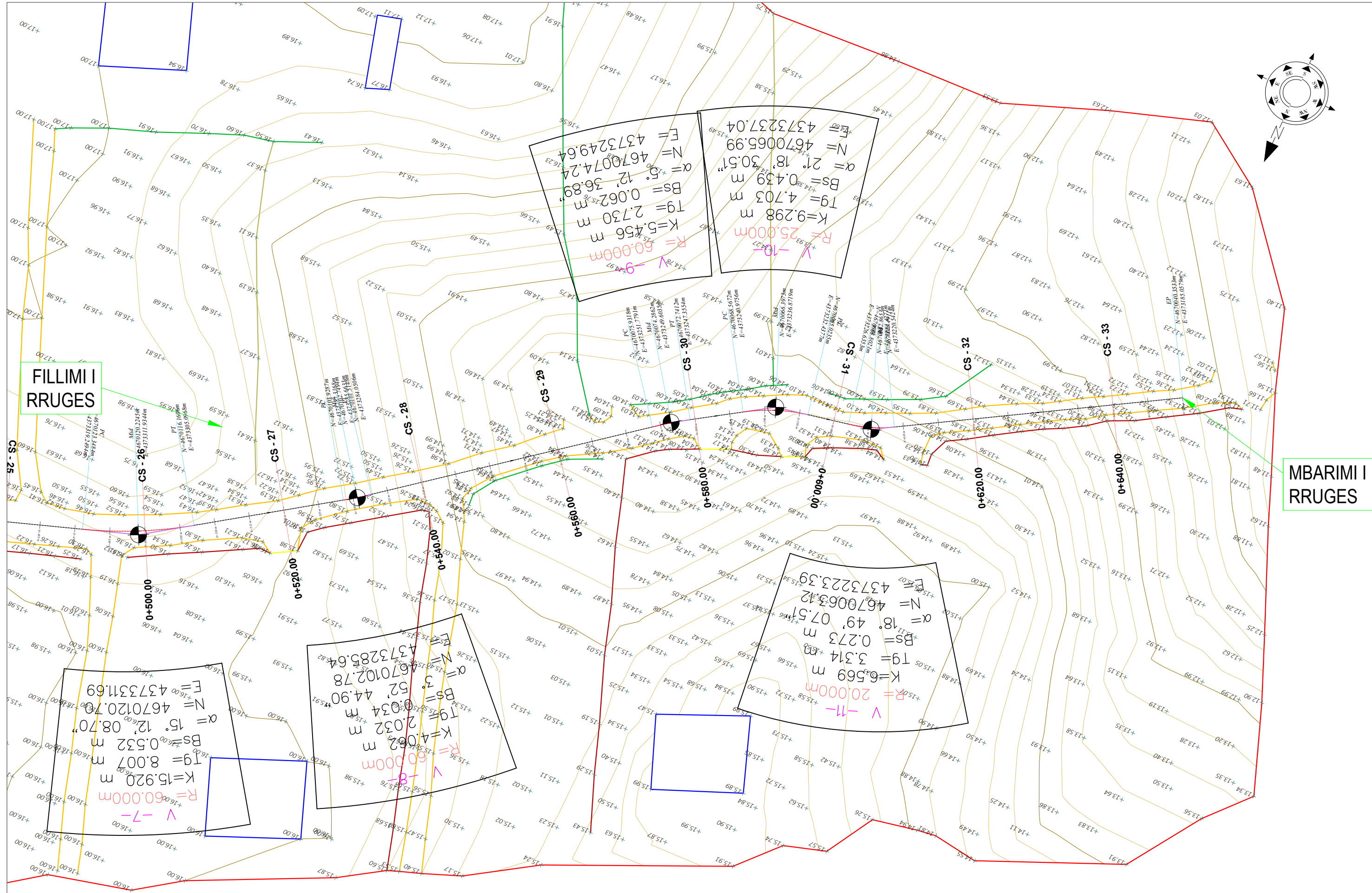
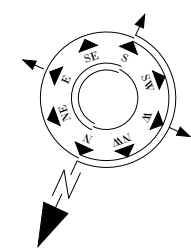

FILLIMI I RRUGES

MBARIMI I RRUGES

SHPJEGUES

- 156.95 Pike detaje
- 158.00 Izohipse
- Objekt
- Kanal Natyral
- Rrethim
- Mur Rrethues

Porositi :
BASHKIA MALESI E MADHE

Projektoi:
"LENI-ING" sh.p.k
Liçense: N.2969
ADMINISTRATOR Nikoll PALUCA
Adresa: Rr. Uran Pano, Pallati 12 kat, Kati 2
Mobile: 0682042270
Email: leni-ing@hotmail.com

Objekti: Sistemim asfaltim rruga Syri I Gjonit		
Faza: Projekt – Zbatim		Emërtimi i Fletës: TOPOGRAFIJA E RRUGES
Shkalla: Sh 1:500	Tiranë 2023	Topo (4)



MIRATOHET
KRYETARI I BASHKISË
Z. TONIN MARINAJ

BASHKIA MALESI E MADHE
PROJEKT ZBATIMI

Sistemim asfaltim rruga Syri I Gjonit

- 1– Hoorografia
- 2– Topografia e rruges
- 3– Planimetria e rruges
- 4– Profili gjatësor
- 5– Profilat tërthore
- 6– Profili tërthore tip

PROJEKTOI:
"LENI-ING" SH.P.K

TIRANË 2023

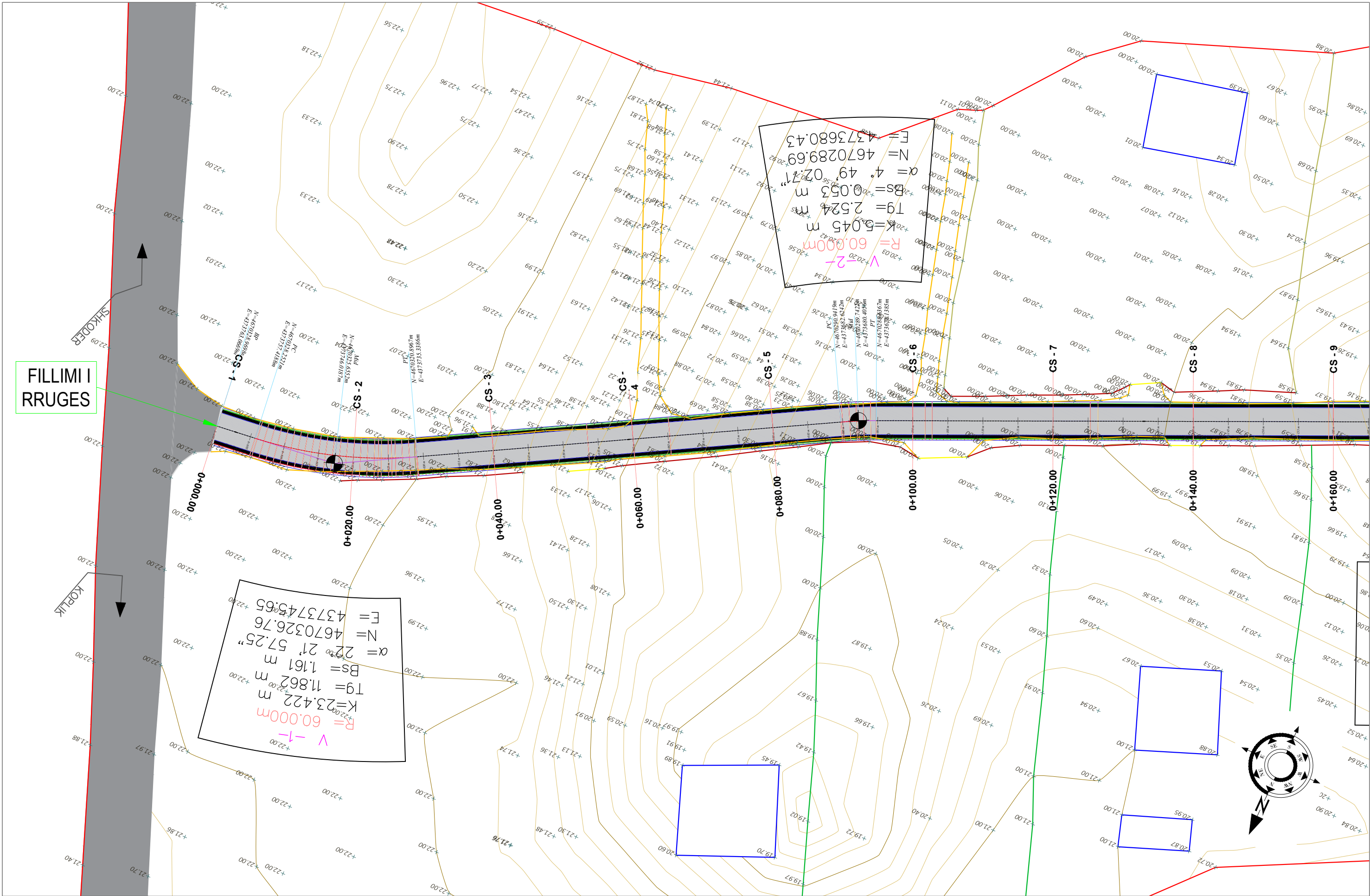

FILLIMI I RRUGES

SHKODER

KOPIK

$E = 4373745.65$
 $N = 4670326.76$
 $\alpha = 27^\circ 21' 57.25''$
 $BS = 1.161 \text{ m}$
 $Tg = 11.862 \text{ m}$
 $K = 23.422 \text{ m}$
 $R = 60.000 \text{ m}$
 $V = \text{---}$

$E = 4373680.43$
 $N = 4670289.69$
 $\alpha = 4^\circ 49' 02.71''$
 $BS = 0.053 \text{ m}$
 $Tg = 2.524 \text{ m}$
 $K = 5.045 \text{ m}$
 $R = 60.000 \text{ m}$
 $V = \text{---}$

SHPJEGUES

- 156.95 Pike detaje
- 158.0 Izohipse
- Objekt
- Kanal Natyral
- Rrethim
- Mur Rrethues

Porositi :
BASHKIA MALESI E MADHE

Projektoi:
"LENI-ING" sh.p.k
Liqense: N.2969
ADMINISTRATOR Nikoll PALUCA
Adresa: Rr. Uran Pano, Pallati 12 kat, Kati 2
Mobile: 0682042270
Email: leni-ing@hotmail.com

Objekti: Sistemim asfaltim rruga Syri I Gjonit		
Faza: Projekt – Zbatim		
Emërtimi i Fletës: PLANIMETRIA E RRUGES	Shkalla: Sh 1:500	Tiranë 2023 PL

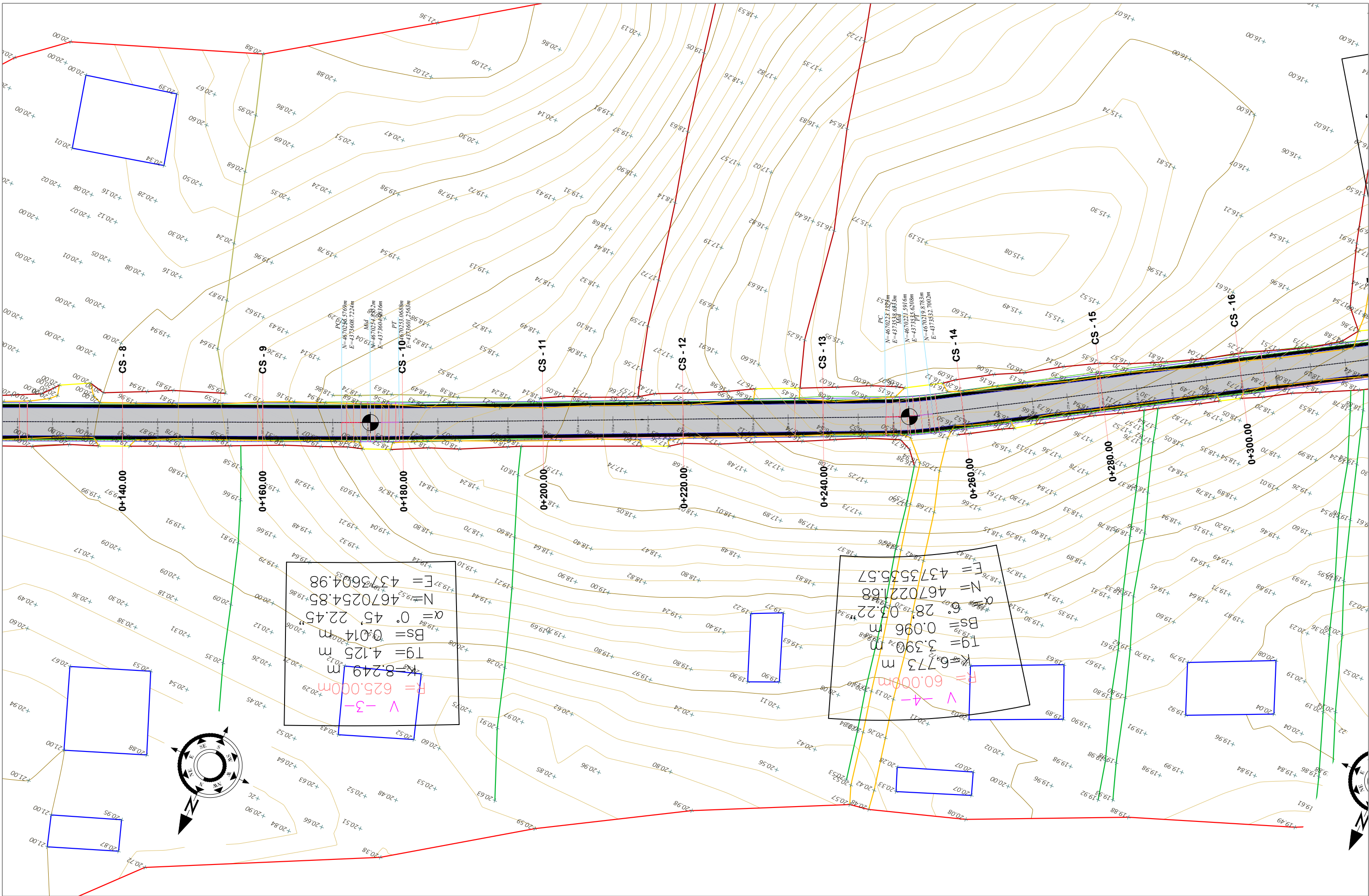

$F = 625.000m$
 $R = 8.219m$
 $Tg = 4.125m$
 $Bs = 0.014m$
 $\alpha = 0^\circ 45' 22.45''$
 $N = 4670254.85$
 $E = 4373604.98$

$F = 60.000m$
 $R = 6.773m$
 $Tg = 3.390m$
 $Bs = 0.096m$
 $\alpha = 6^\circ 28' 05.22''$
 $N = 4670221.68$
 $E = 4373535.57$

SHPJEGUES

- 156.95 Pike detaje
- 158.00 Izohipse
- Objekt
- Kanal Natyral
- Rrethim
- Mur Rrethues

Porositi :
 BASHKIA
 MALESI E
 MADHE

Projektoi:
 "LENI-ING" sh.p.k
 Liçense: N.2969
 ADMINISTRATOR Nikoll PALUCA
 Adresa: Rr. Uran Pano, Pallati 12 kat, Kati 2
 Mobile: 0682042270
 Email: leni-ing@hotmail.com

Objekti: Sistemim asfaltim rruga Syri I Gjonit		
Faza:		Projekt – Zbatim
Emërtimi i Fletës:	Shkalla:	Tiranë 2023
PLANIMETRIA E RRUGES	Sh 1:500	PL (2)

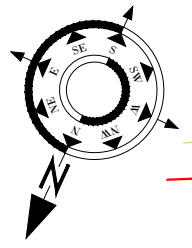
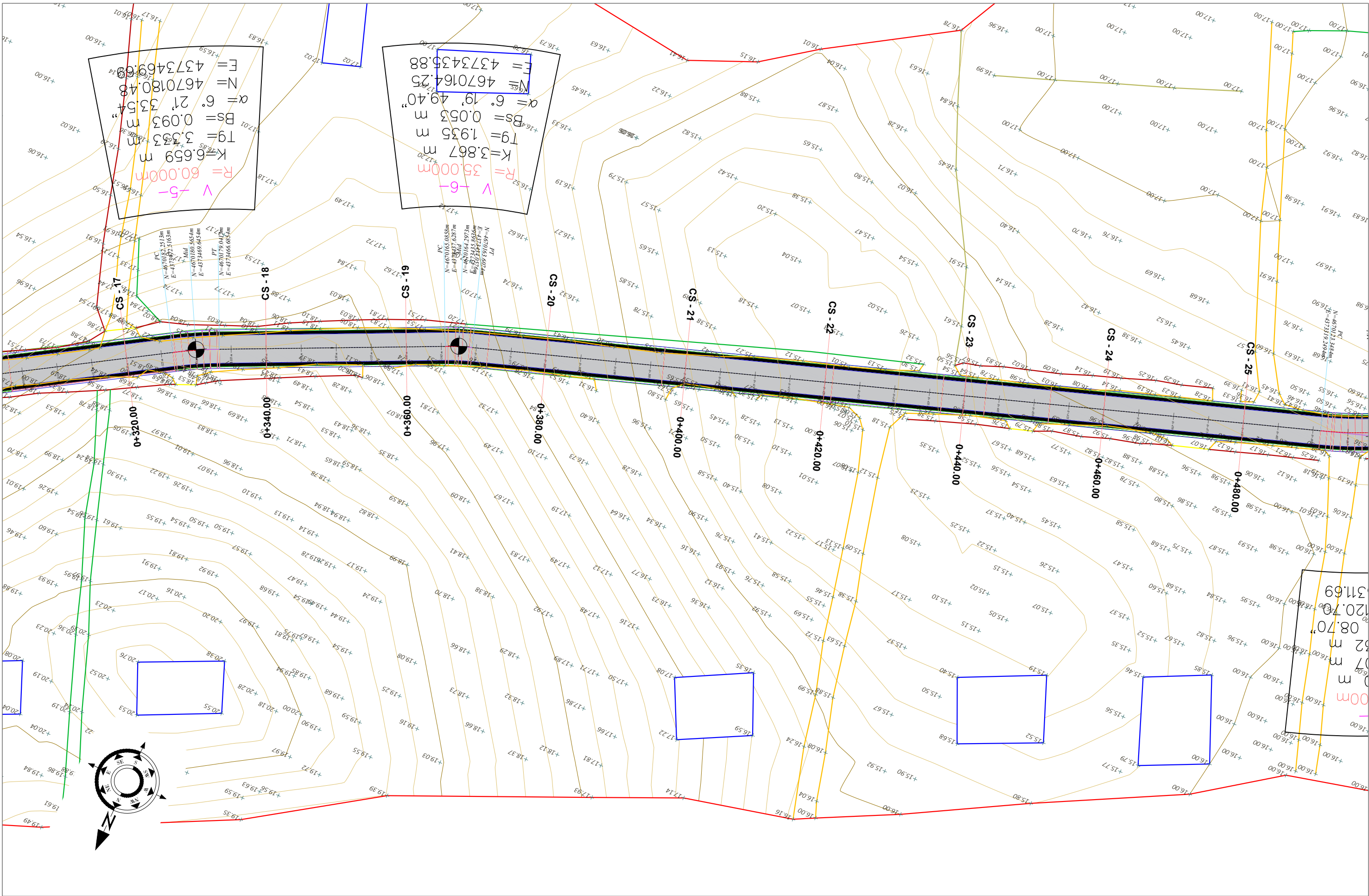

SHPJEGUES

- 156.95 Pike detaje
- 158.00 Izohipse
- Objekt
- Kanal Natyral
- Rrethim
- Mur Rrethues

Porositi :
 BASHKIA
 MALESI E
 MADHE

Projektoi:
 "LENI-ING" sh.p.k
 Liçense: N.2969
 ADMINISTRATOR Nikoll PALUCA
 Adresa: Rr. Uran Pano, Pallati 12 kat, Kati 2
 Mobile: 0682042270
 Email: leni-ing@hotmail.com

Objekti: Sistemim asfaltim rruga Syri I Gjonit		
Faza:		Projekt – Zbatim
Emërtimi i Fletës:	Shkalla:	Tiranë 2023
PLANIMETRIA E RRUGES	Sh 1:500	PL (3)

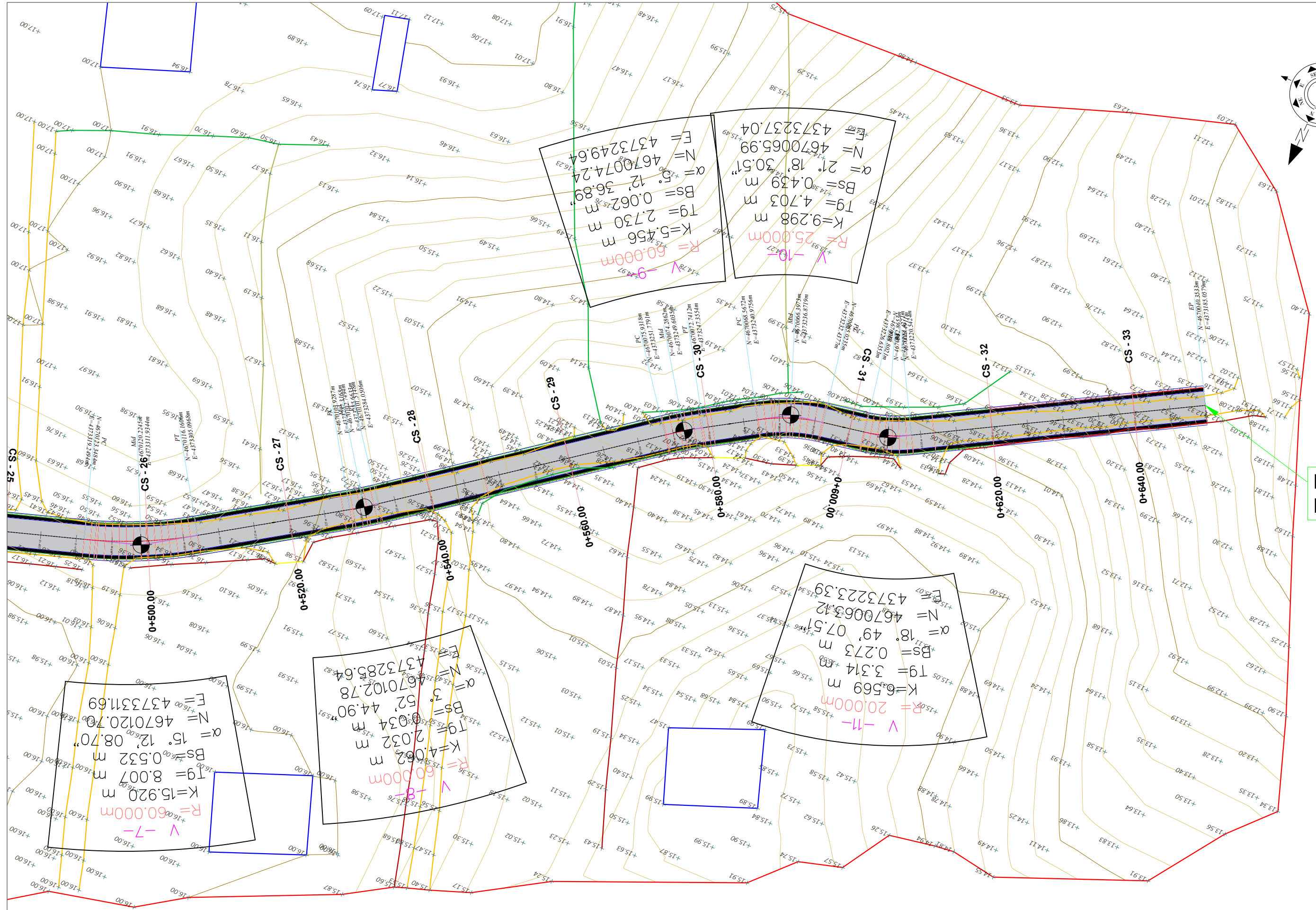
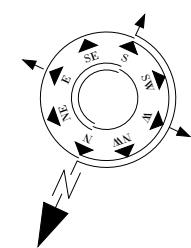

MBARIMI I RRUGES

SHPJEGUES 156.95 158.0 Objekt Kanal Natyral Rrethim Mur Rrethues	Porositi : BASHKIA MALESI E MADHE	Projektoi: "LENI-ING" sh.p.k Liçense: N.2969 ADMINISTRATOR Nikoll PALUCA	Objekti: Sistemim asfaltim rruga Syri I Gjonit	
	Adresa: Rr. Uran Pano, Pallati 12 kat, Kati 2 Mobile: 0682042270 Email: leni-ing@hotmail.com	Fazat: Projekt – Zbatim	Emërtimi i Fletës: PLANIMETRIA E RRUGES	Shkalla: Sh 1:500



MIRATOHET
KRYETARI I BASHKISË
Z. TONIN MARINAJ

BASHKIA MALESI E MADHE
PROJEKT ZBATIMI

Sistemim asfaltim rruga Syri I Gjonit

- 1– Hoorografia
- 2– Topografia e rruges
- 3– Planimetria e rruges
- 4– Profili gjatësor
- 5– Profilat tërthore
- 6– Profili tërthore tip

PROJEKTOI:
"LENI-ING" SH.P.K

TIRANË 2023

PROFILI GIATESOR
Aksi 1 Rruga Syri Gjonit
SH_N - 1:1000
SH_V - 1:250

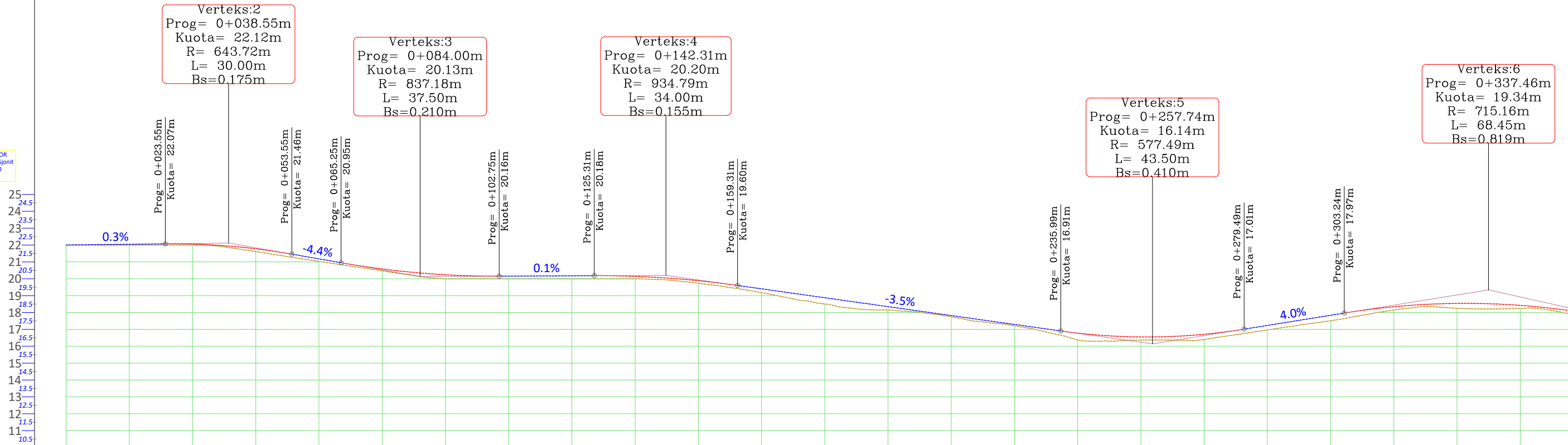

NRI PRERJES	CS-1	CS-2	CS-3	CS-4	CS-5	CS-6	CS-7	CS-8	CS-9	CS-10	CS-11	CS-12	CS-13	CS-14	CS-15	CS-16	CS-17	CS-18		
DIST. PJESORE	20.0 m	20.0 m	20.0 m	20.0 m	20.0 m	20.0 m	20.0 m	20.0 m	20.0 m	20.0 m	20.0 m	20.0 m	20.0 m	20.0 m	20.0 m	20.0 m	20.0 m	20.0 m		
DIST. PROGRESSIVE	+0+000	+0+020	+0+040	+0+060	+0+080	+0+100	+0+120	+0+140	+0+160	+0+180	+0+200	+0+220	+0+240	+0+260	+0+280	+0+300	+0+320	+0+340		
KUOTA TOKES	22.00	22.00	21.80	21.03	20.28	20.00	20.00	19.96	19.39	18.51	18.07	17.37	16.38	16.37	16.78	17.51	18.30	18.21		
KUOTA PROJEKTIT	22.00	22.06	21.91	21.18	20.44	20.16	20.18	20.08	19.58	18.88	18.17	17.47	16.78	16.56	17.03	17.84	18.44	18.50		
KUOTA PUNES	0.00	-0.06	-0.11	-0.15	-0.16	-0.16	-0.18	-0.12	-0.19	-0.37	-0.11	-0.10	-0.40	-0.19	-0.26	-0.32	-0.14	-0.28		
GJEO. VERTIKALE	L=23.55 i=0.30%		R=643.72 K=30.00		L=37.50 i=-4.36%		R=837.18 K=37.50		L=22.56 i=0.12%		R=934.79 K=34.00		L=76.69 i=-3.52%		R=577.49 K=43.50		L=23.75 i=4.01%		R=715.16 K=68.45	
GJEO. HORIZONTALE	φ = 22°21'57" L=23.42 R=60.00		L=60.63		φ = 4°49'03" L=5.04 R=60.00		L=76.46		φ = 0°45'22" L=8.25 R=625.00		L=69.41		φ = 6°28'03" L=6.77 R=60.00		L=70.98		φ = 6°21'34" L=6.64 R=60.00		L=32.23	
KILOMETRAZHI	0.01		0.05		0.10		0.15		0.20		0.25		0.30		0.35					

Porositi :
BASHKIA
MALESI E
MADHE

Projektoi:
"LENI-ING" sh.p.k
Liçense: N.2969
ADMINISTRATOR Nikoll PALUCA
Adresa: Rr. Uran Pano, Pallati 12 kat, Kati 2
Mobile: 0682042270
Email: leni-ing@hotmail.com

Objekti: Sistemim asfaltim rruga Syri I Gjonit
Faza: Projekt - Zbatim
Emërtimi i Fletës: PROFILI GIATESORE
Shkalla: 1:1000
1:250
Tiranë 2023
PGJ

PROFILI GIATESOR
Aksi 1 Rruga Syri Gjonit
SH_N - 1:1000
SH_V - 1:250

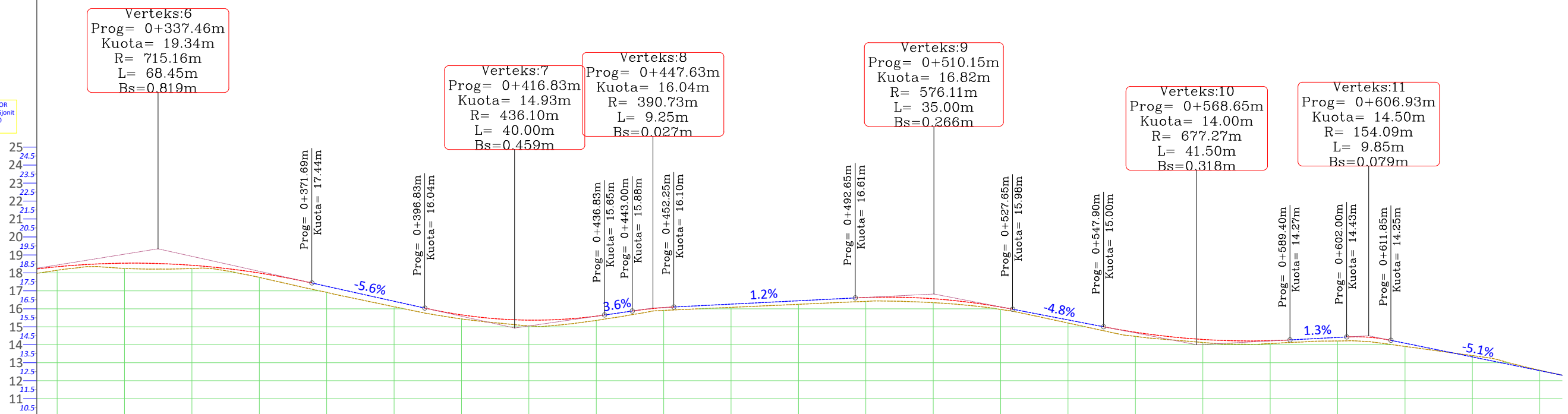

NR I PRERJES	CS - 17	CS - 18	CS - 19	CS - 20	CS - 21	CS - 22	CS - 23	CS - 24	CS - 25	CS - 26	CS - 27	CS - 28	CS - 29	CS - 30	CS - 31	CS - 32	CS - 33
DIST. PJESORE	m	20.0 m	20.0 m	20.0 m	20.0 m	20.0 m	20.0 m	20.0 m	20.0 m	20.0 m	20.0 m	20.0 m	20.0 m	20.0 m	20.0 m	20.0 m	20.0 m
DIST. PROGRESIVE		0+320	0+340	0+360	0+380	0+400	0+420	0+440	0+460	0+480	0+500	0+520	0+540	0+560	0+580	0+600	0+640
KUOTA TOKES		18.30	18.21	17.75	16.64	15.63	15.05	15.55	16.03	16.25	16.43	16.14	15.21	14.33	14.02	14.21	13.74
KUOTA PROJEKTTIT		18.44	18.50	17.99	16.98	15.88	15.37	15.77	16.20	16.45	16.65	16.30	15.38	14.53	14.21	14.41	13.83
KUOTA PUNES		-0.14	-0.28	-0.24	-0.34	-0.25	-0.32	-0.22	-0.17	-0.20	-0.22	-0.16	-0.17	-0.19	-0.19	-0.20	-0.09
GJEO. VERTIKALE		R = 715.16 K = 68.45	L = 25.14 i = -5.56%	R = 436.10 K = 40.00	L = 39.18 K = 9.25	L = 40.40 i = 1.25%	R = 576.11 K = 35.00	L = 20.25 i = -4.83%	R = 677.27 K = 41.50	L = 12.60 i = 1.30%	R = 154.09 K = 9.85	L = 38.12 i = -5.03%					
GJEO. HORIZONTALE		$\phi = 6^{\circ}21'34''$ L = 6.66 R = 60.00	L = 32.23	$\phi = 6^{\circ}14'49''$ L = 3.87 R = 35.00	L = 121.66	$\phi = 15^{\circ}12'09''$ L = 15.92 R = 60.00	L = 21.58	$\phi = 3^{\circ}52'45''$ L = 4.06 R = 60.00	L = 41.18	$\phi = 5^{\circ}12'37''$ L = 5.46 R = 60.00	$\phi = 21^{\circ}18'31''$ L = 9.30 R = 25.00	$\phi = 18^{\circ}49'08''$ L = 6.57 R = 20.00					
KILOMETRAZHI	0	0.35	0.40	0.45	0.50	0.55	0.60	0.65	0.67								

Porositi :
BASHKIA
MALESI E
MADHE

Projektoi:
"LENI-ING" sh.p.k
Liçense: N.2969
ADMINISTRATOR Nikoll PALUCA
Adresa: Rr. Uran Pano, Pallati 12 kat, Kati 2
Mobile: 0682042270
Email: leni-ing@hotmail.com

Objekti: SISTEMIM ASFALTIM RRUGA "MULLINI"
Faza: Projekt - Zbatim
Emërtimi i Fletës: PROFILI GJATESORE
Shkalla: 1:1000
1:250
Tiranë 2023
PGJ
(2)

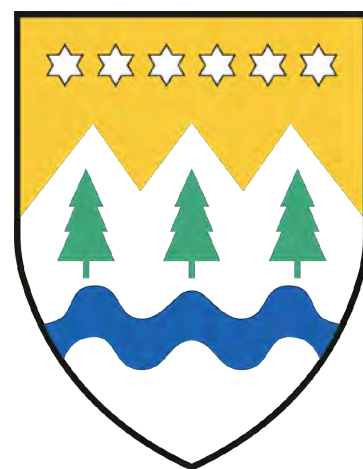

MIRATOHET
KRYETARI I BASHKISË
Z. TONIN MARINAJ

BASHKIA MALESI E MADHE
PROJEKT ZBATIMI

Sistemim asfaltim rruga Syri I Gjonit

- 1– Hoorografia
- 2– Topografia e rruges
- 3– Planimetria e rruges
- 4– Profili gjatësor
- 5– Profilat tërthore
- 6– Profili tërthore tip

PROJEKTOI:
"LENI-ING" SH.P.K

TIRANË 2023

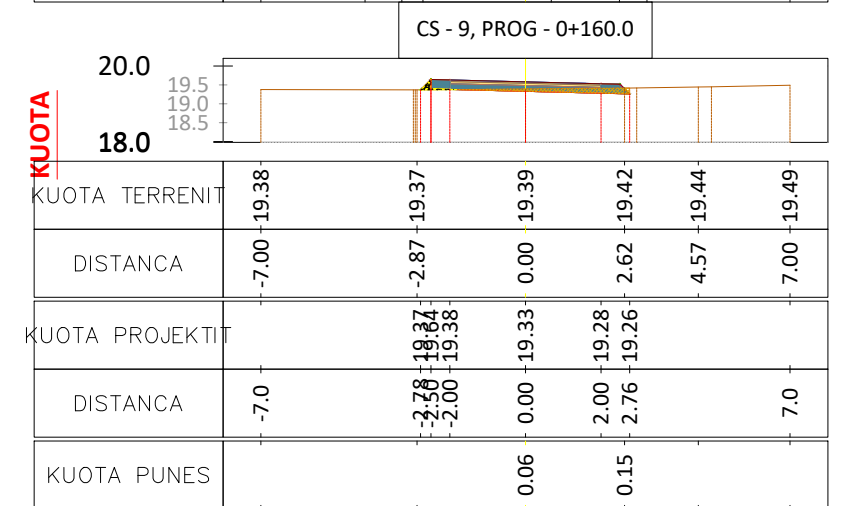
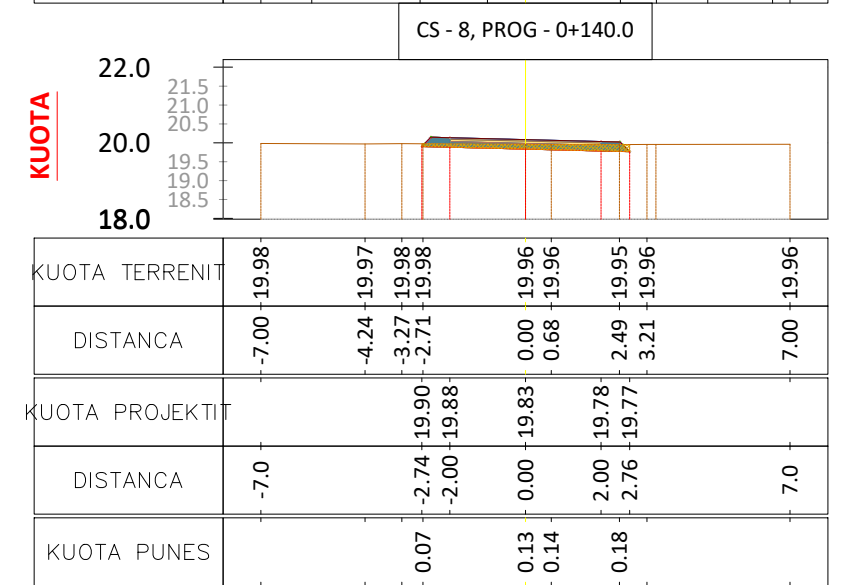
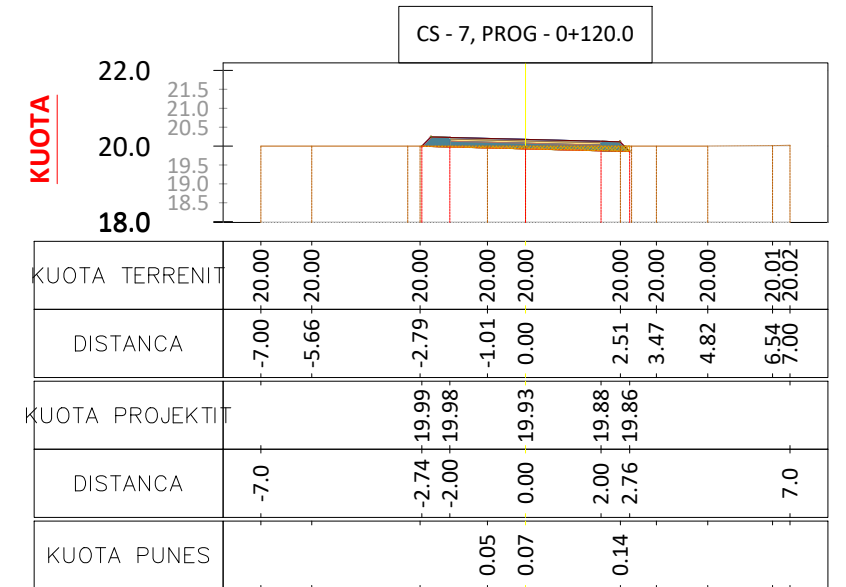
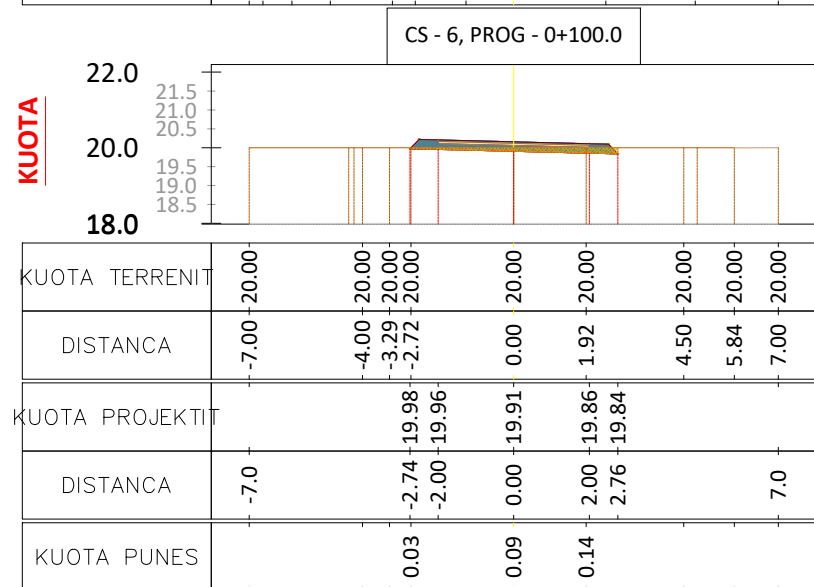
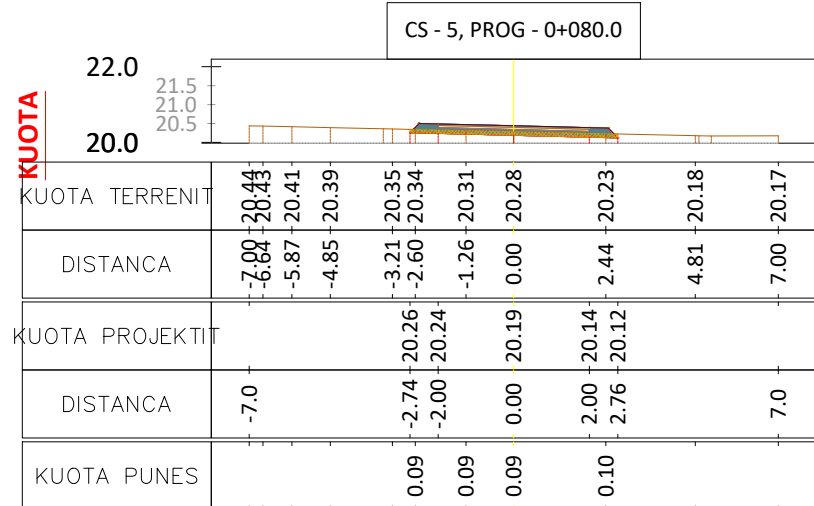
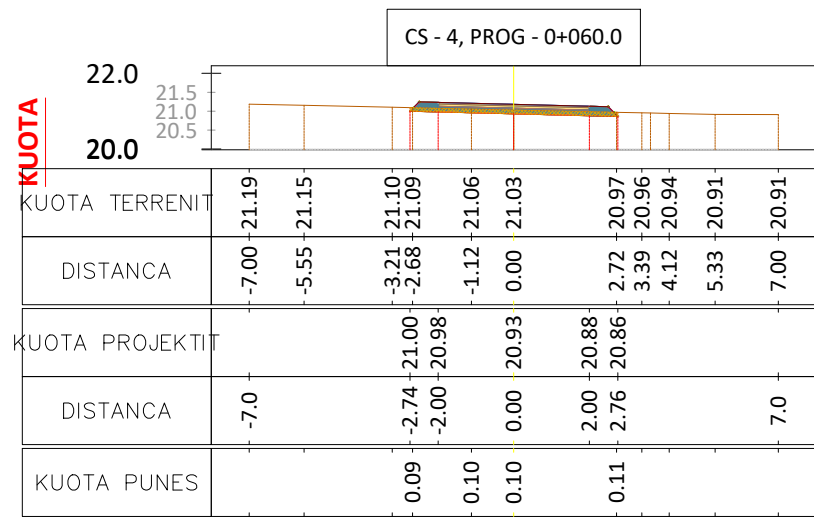
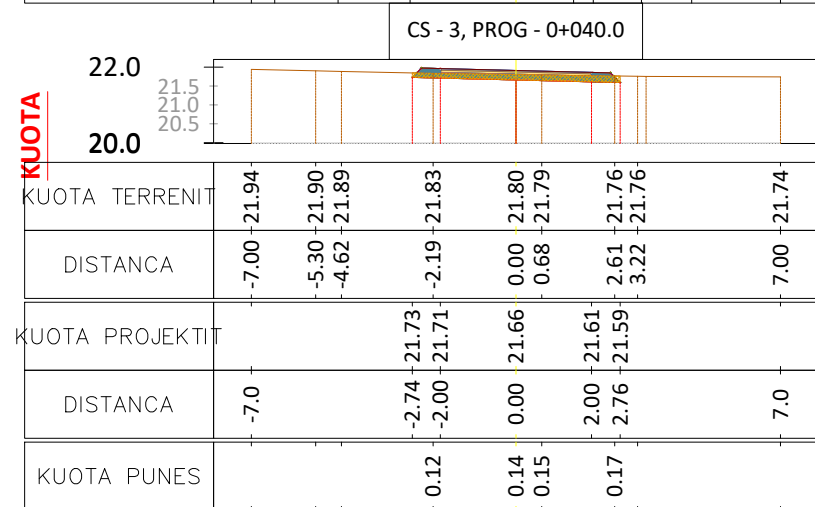
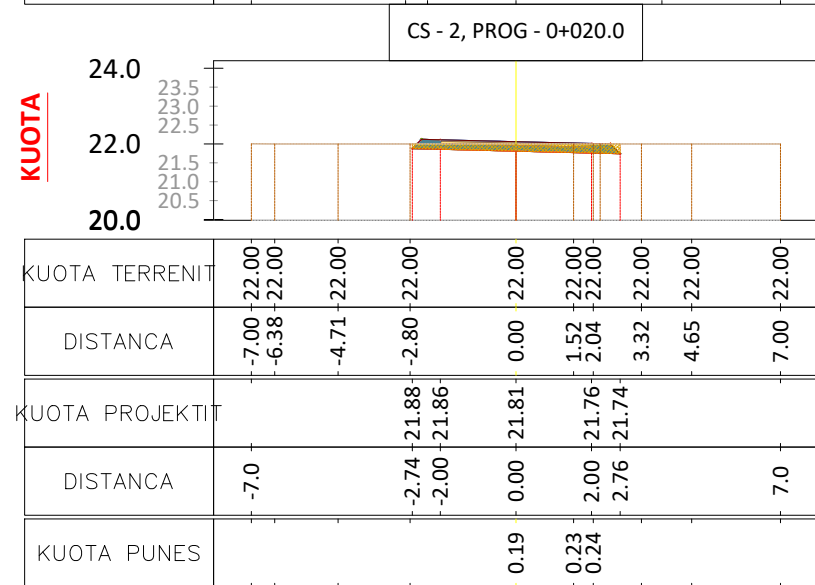
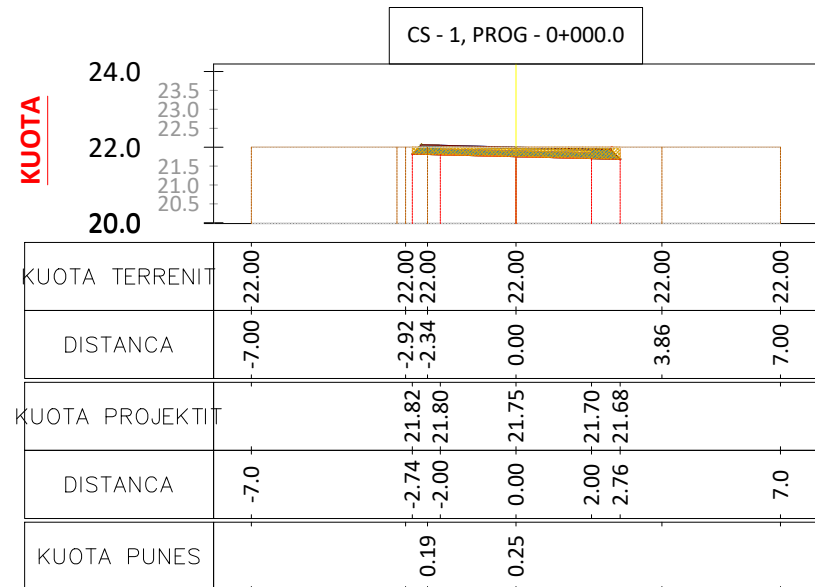

Porositi :
BASHKIA
MALESI E
MADHE

Projektoi:
"LENI-ING" sh.p.k
Liçense: N.2969
ADMINISTRATOR Nikoll PALUCA
Adresa: Rr. Uran Pano, Pallati 12 kat, Kati 2
Mobile: 0682042270
Email: leni-ing@hotmail.com

Objekti: Sistemim asfaltim rruga Syri I Gjonit

Faza: Projekt - Zbatim

Emërtimi i Fletës: PROFILAT TERTHORE
Shkalla: 1:200
Tiranë 2023
PTTH

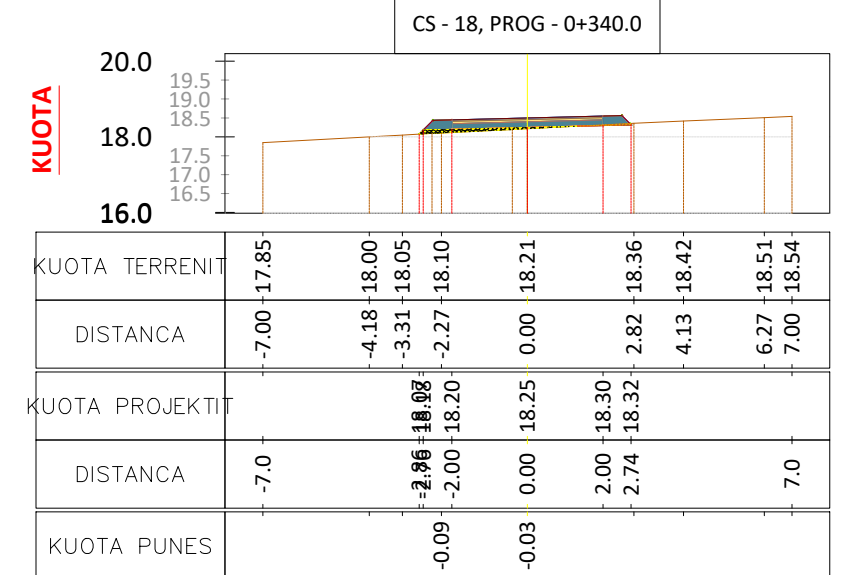
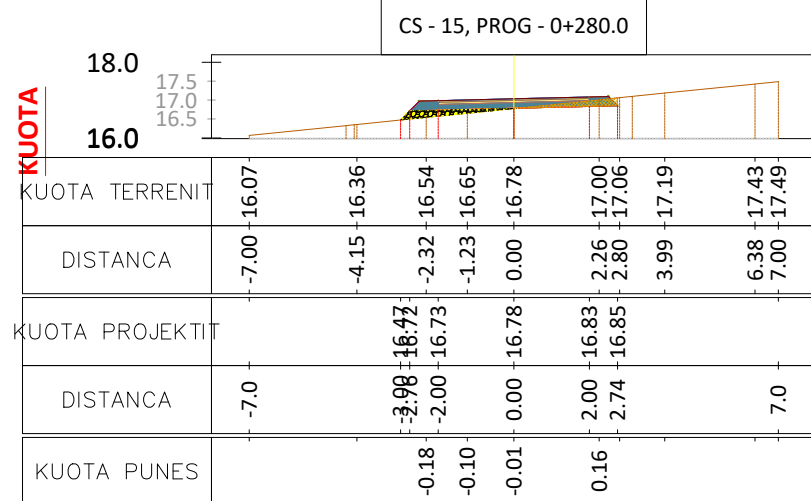
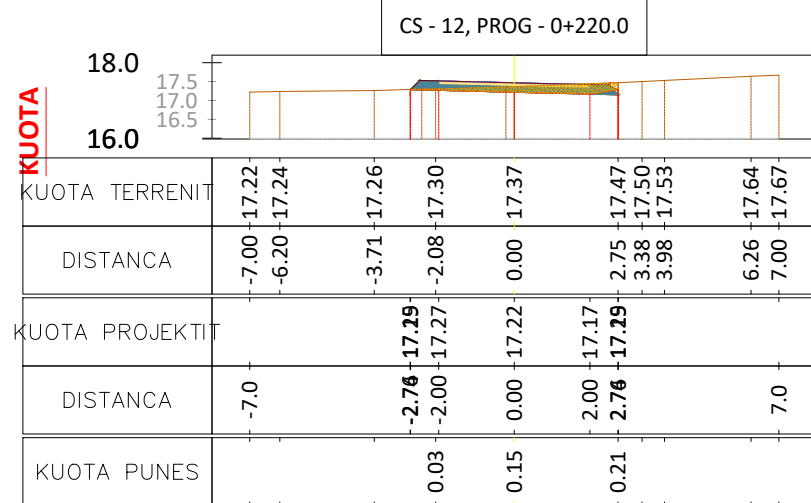
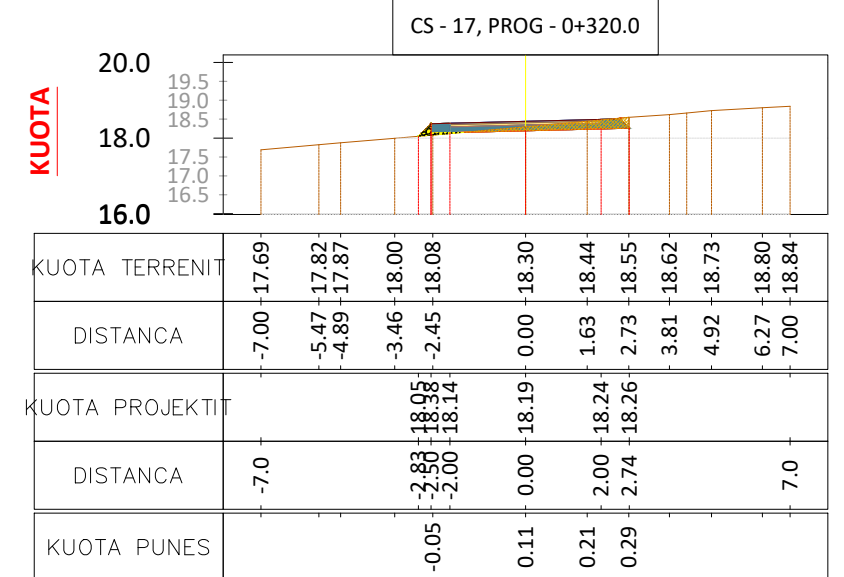
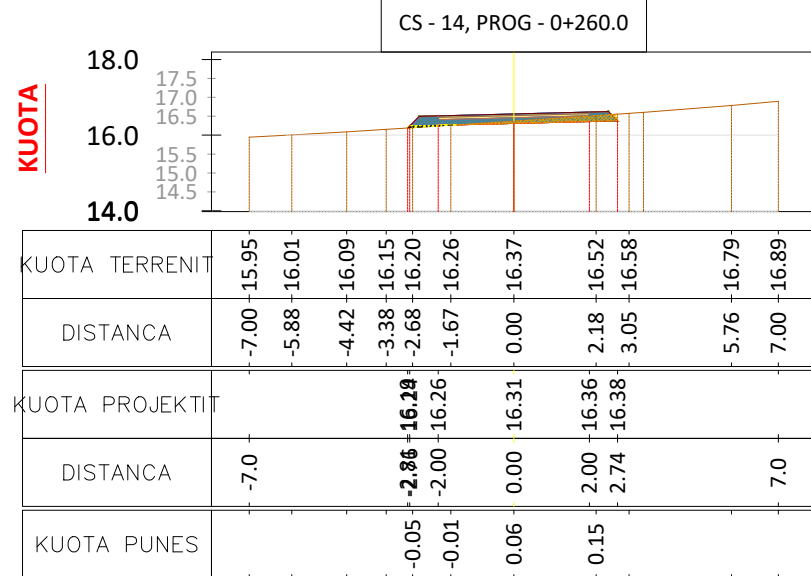
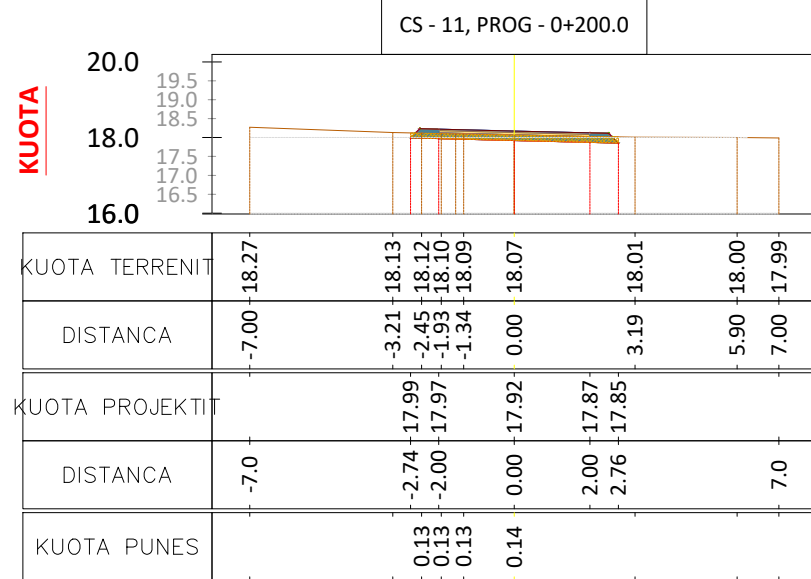
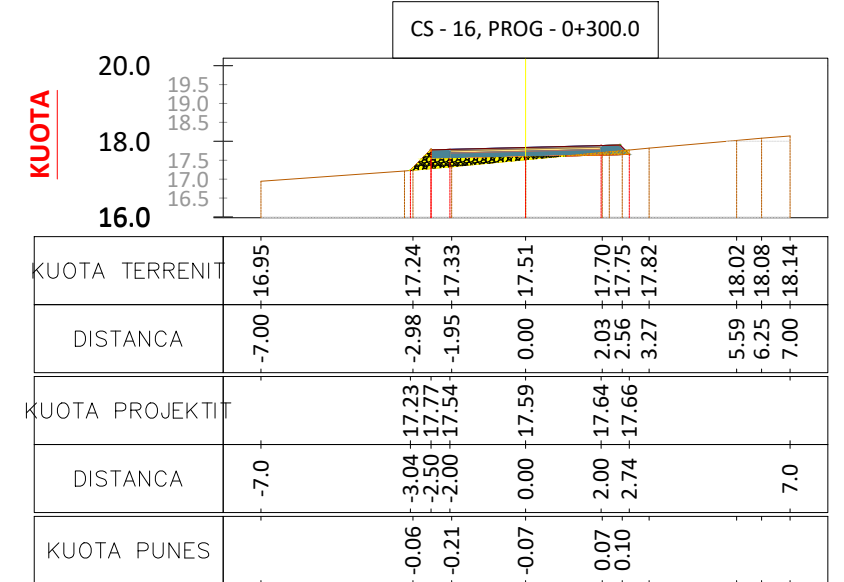
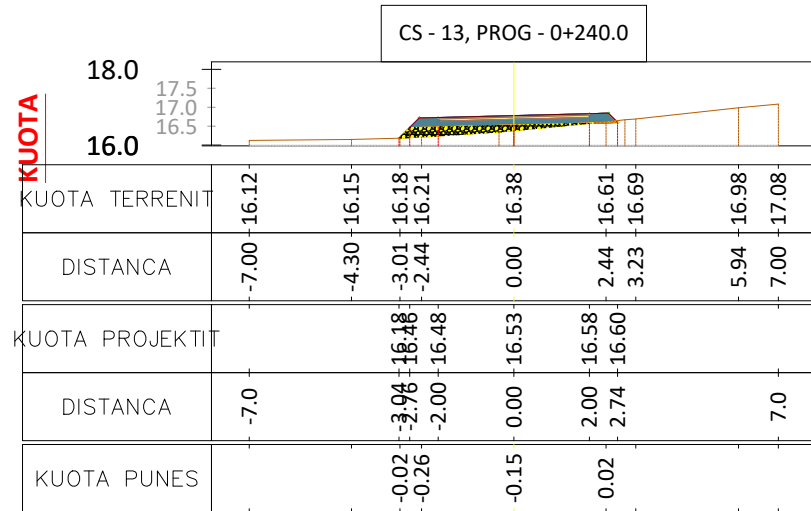
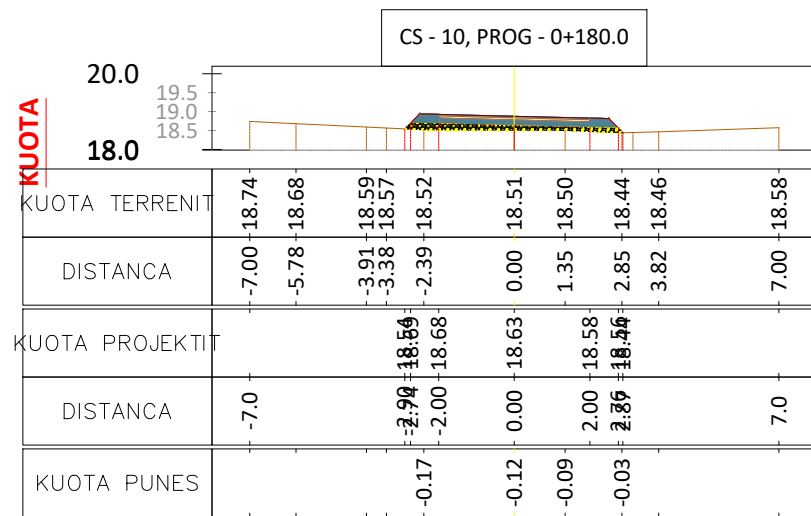

Porositi :
BASHKIA
MALESI E
MADHE

Projektoi:
"LENI-ING" sh.p.k
Liçense: N.2969
ADMINISTRATOR Nikoll PALUCA
Adresa: Rr. Uran Pano, Pallati 12 kat, Kati 2
Mobile: 0682042270
Email: leni-ing@hotmail.com

Objekti: Sistemim asfaltim rruga Syri I Gjonit

Faza: Projekt - Zbatim

Emërtimi i Fletës: PROFILAT TERTHORE
Shkalla: 1:200
Tiranë 2023
PTTH (2)

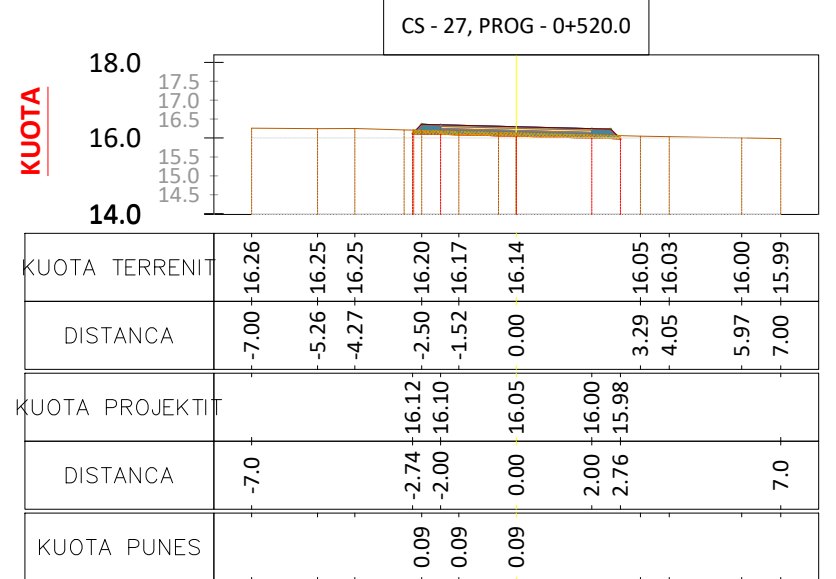
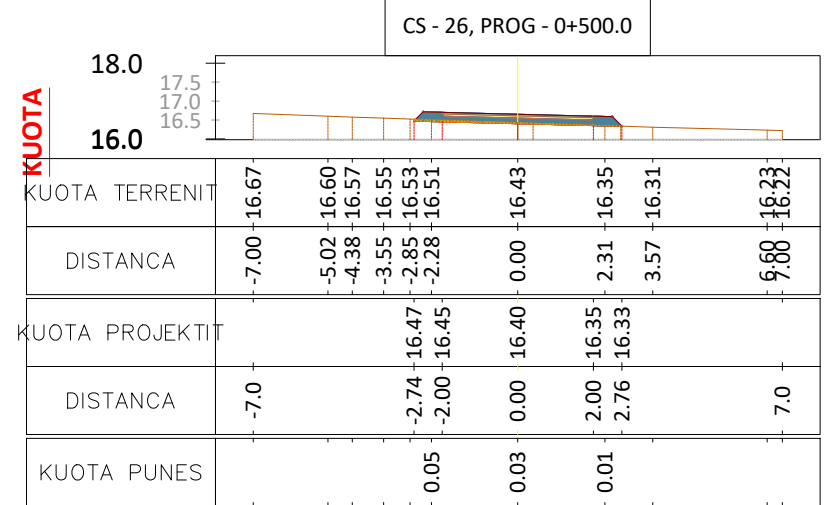
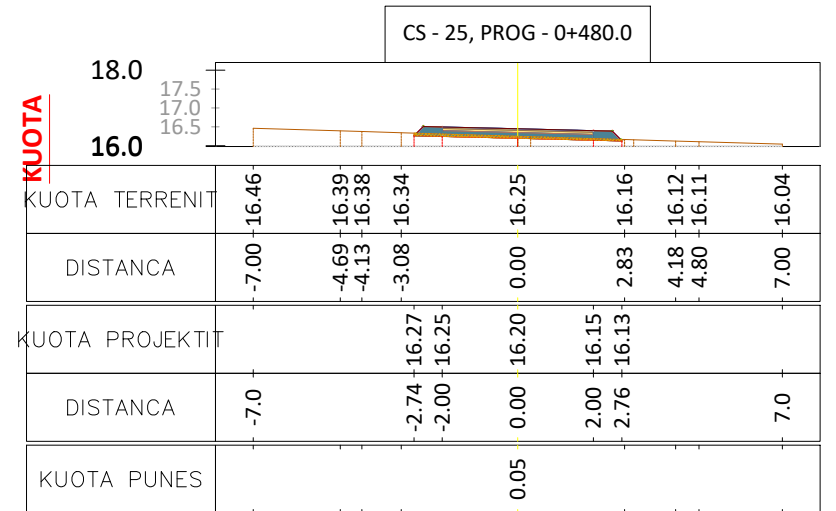
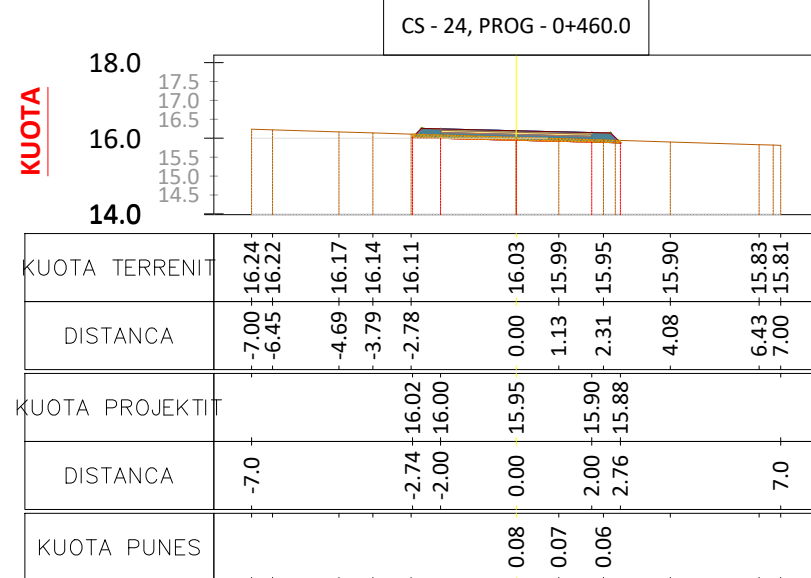
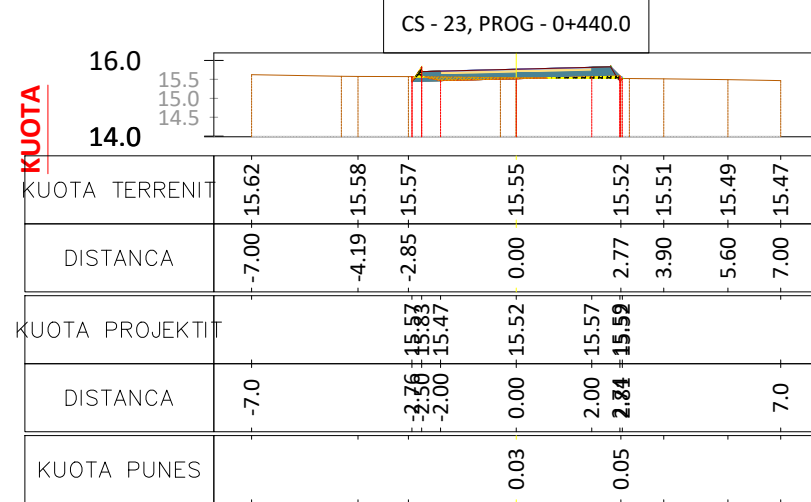
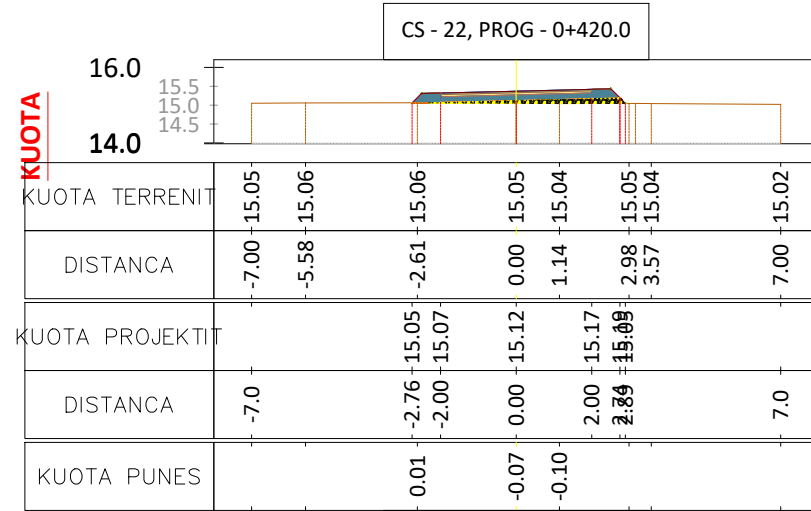
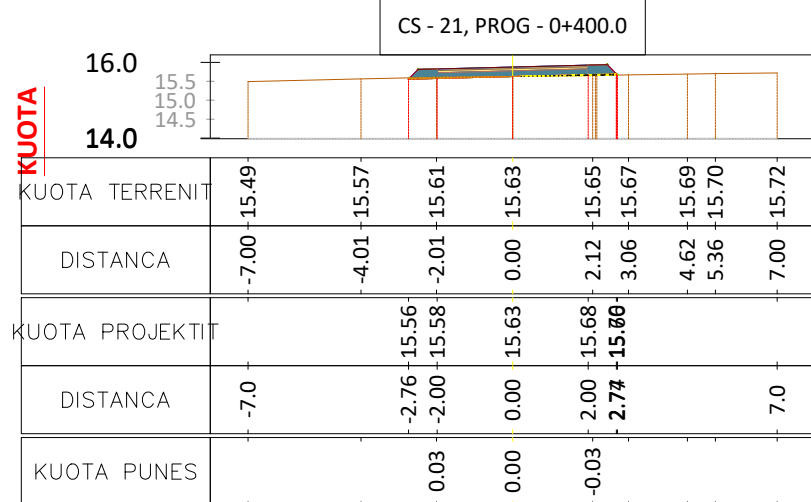
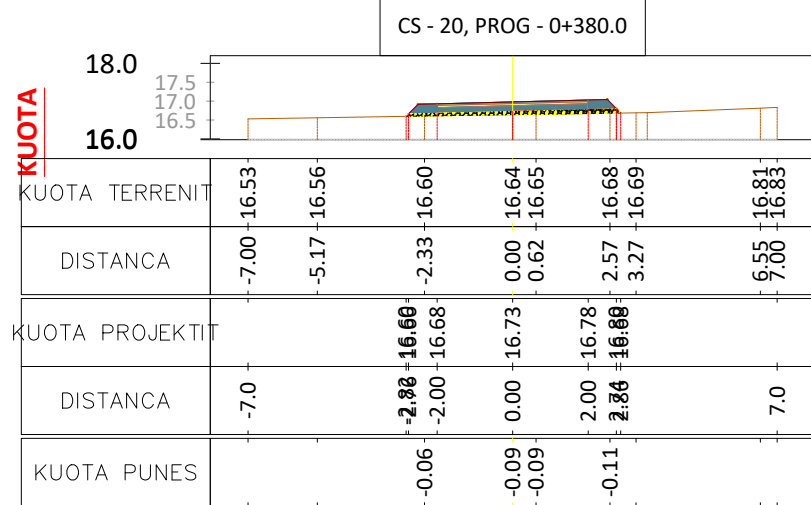
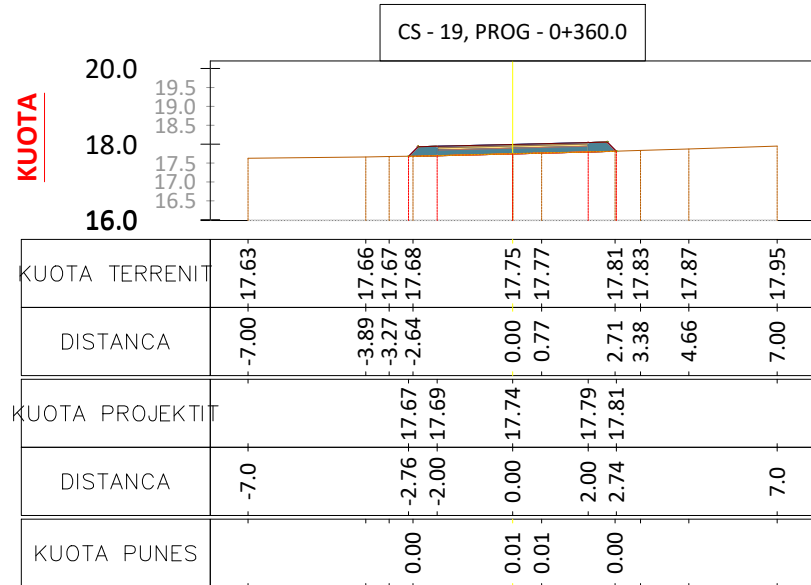

Porositi :
BASHKIA
MALESI E
MADHE

Projektoi:
"LENI-ING" sh.p.k
Liçense: N.2969
ADMINISTRATOR Nikoll PALUCA
Adresa: Rr. Uran Pano, Pallati 12 kat, Kati 2
Mobile: 0682042270
Email: leni-ing@hotmail.com

Objekti: Sistemim asfaltim rruga Syri I Gjonit

Faza: Projekt - Zbatim

Emërtimi i Fletës:
PROFILAT
TERTHORE

Shkalla:
1:200

Tiranë 2023
PTTH
(3)

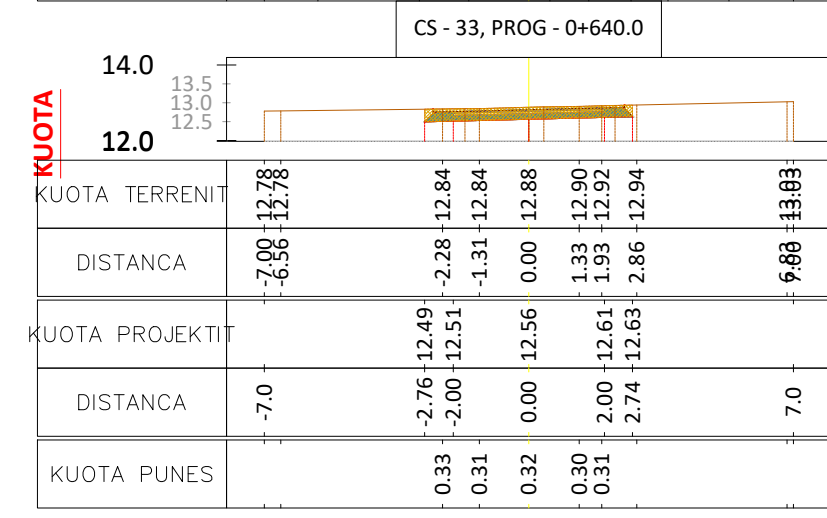
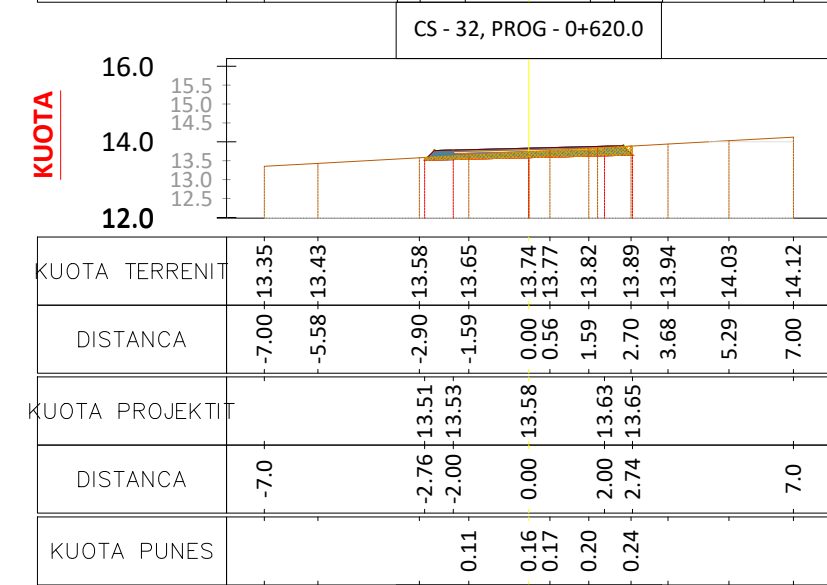
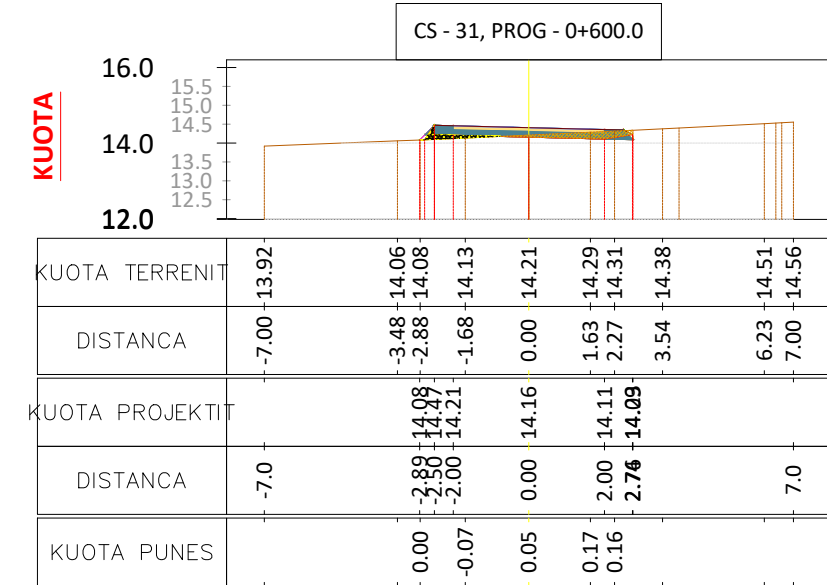
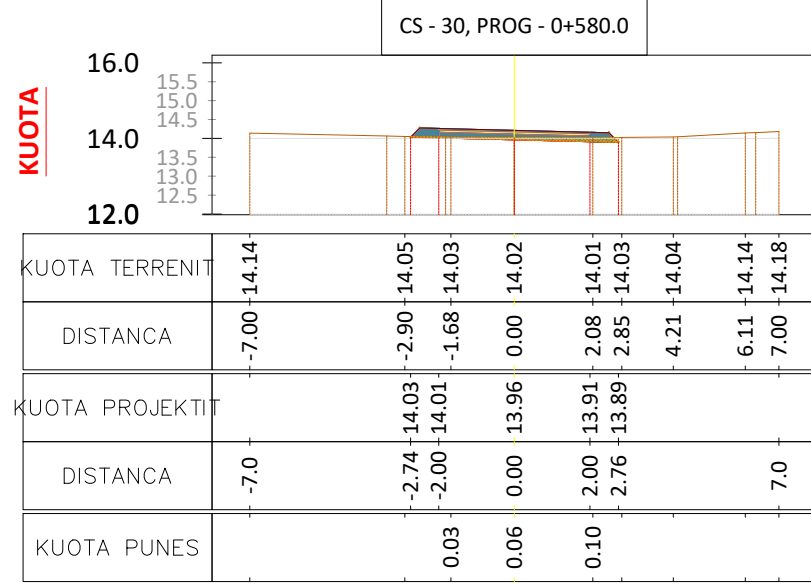
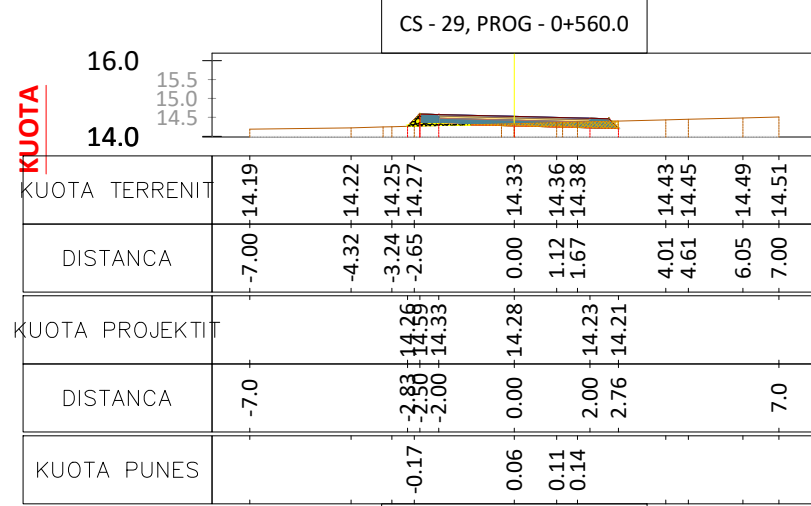
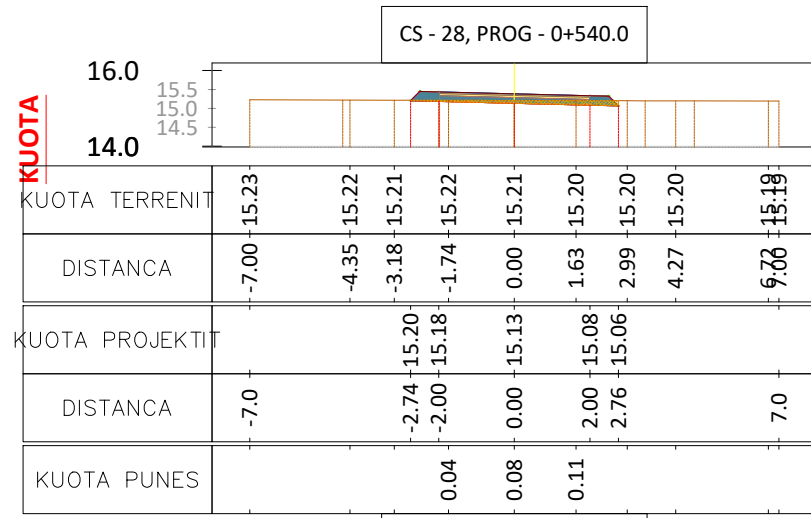

Porositi :
BASHKIA
MALESI E
MADHE

Projektoi:
"LENI-ING" sh.p.k
Liçense: N.2969
ADMINISTRATOR Nikoll PALUCA
Adresa: Rr. Uran Pano, Pallati 12 kat, Kati 2
Mobile: 0682042270
Email: leni-ing@hotmail.com

Objekti: Sistemim asfaltim rruga Syri I Gjonit
Faza: Projekt - Zbatim
Emërtimi i Fletës: PROFILAT TERTHORE
Shkalla: 1:200
Tiranë 2023
PTTH (4)

TABELA VOLUMEVE							
PROGRESIVA	SIP. GERMIM	SIP. MBUSHJE	VOL. GERMIM	VOL. MBUSHJE	G. PROGRESIV	M. PROGRESIV	G-M
0+00.00	1.38	0.00	0.00	0.00	0.00	0.00	0.00
0+20.00	1.05	0.00	24.31	0.00	24.31	0.00	24.31
0+40.00	0.78	0.00	18.31	0.00	42.61	0.00	42.61
0+60.00	0.56	0.00	13.37	0.00	55.99	0.00	55.99
0+80.00	0.52	0.00	10.78	0.00	66.77	0.00	66.77
1+00.00	0.51	0.00	10.32	0.00	77.09	0.00	77.09
1+20.00	0.41	0.00	9.20	0.00	86.30	0.00	86.30
1+40.00	0.70	0.00	11.08	0.00	97.37	0.00	97.37
1+60.00	0.36	0.05	10.56	0.45	107.94	0.45	107.48
1+80.00	0.00	0.71	3.56	7.55	111.50	8.00	103.49
2+00.00	0.79	0.00	7.91	7.10	119.41	15.11	104.30
2+20.00	0.81	0.00	15.97	0.00	135.37	15.11	120.26
2+40.00	0.01	0.78	8.21	7.84	143.58	22.94	120.64
2+60.00	0.37	0.03	3.90	8.10	147.48	31.04	116.44
2+80.00	0.27	0.34	6.40	3.68	153.88	34.72	119.16
3+00.00	0.10	0.57	3.65	9.10	157.52	43.82	113.70
3+20.00	0.62	0.07	7.19	6.48	164.72	50.31	114.41
3+40.00	0.03	0.22	6.44	2.93	171.16	53.24	117.92
3+60.00	0.03	0.00	0.61	2.16	171.76	55.40	116.36
3+80.00	0.00	0.49	0.33	4.87	172.10	60.27	111.83
4+00.00	0.06	0.04	0.58	5.32	172.68	65.59	107.09
4+20.00	0.00	0.39	0.61	4.35	173.29	69.94	103.35
4+40.00	0.16	0.08	1.66	4.74	174.95	74.68	100.27
4+60.00	0.42	0.00	5.85	0.83	180.80	75.50	105.30
4+80.00	0.29	0.00	7.11	0.00	187.90	75.50	112.40
5+00.00	0.16	0.00	4.47	0.00	192.38	75.50	116.87
5+20.00	0.49	0.00	6.45	0.00	198.83	75.50	123.32
5+40.00	0.42	0.00	9.07	0.00	207.90	75.50	132.40
5+60.00	0.38	0.10	8.02	0.97	215.92	76.47	139.45
5+80.00	0.35	0.00	7.25	0.98	223.17	77.45	145.72
6+00.00	0.39	0.16	7.18	1.63	230.35	79.09	151.26
6+20.00	0.86	0.00	12.60	1.52	242.95	80.60	162.35
6+40.00	1.73	0.00	25.91	0.00	268.86	80.60	188.26

Porositi :

BASHKIA
MALESI E
MADHE

Projektoi:

"LENI-ING" sh.p.k
Liçense: N.2969

ADMINISTRATOR Nikoll PALUCA

Adresa: Rr. Uran Pano, Pallati 12 kat, Kati 2
Mobile: 0682042270
Email: leni-ing@hotmail.com

Objekti: Sistemim asfaltim rruga Syri I Gjonit

Faza: Projekt – Zbatim

Emërtimi i Fletës:

PROFILAT
TERTHORE

Shkalla:

Tiranë 2023

PTTH
(5)



MIRATOHET
KRYETARI I BASHKISË
Z. TONIN MARINAJ

BASHKIA MALESI E MADHE
PROJEKT ZBATIMI

Sistemim asfaltim rruga Syri I Gjonit

- 1– Hoorografia
- 2– Topografia e rruges
- 3– Planimetria e rruges
- 4– Profili gjatësor
- 5– Profilat tërthore
- 6– Profili tërthore tip

PROJEKTOI:
"LENI-ING" SH.P.K

TIRANË 2023

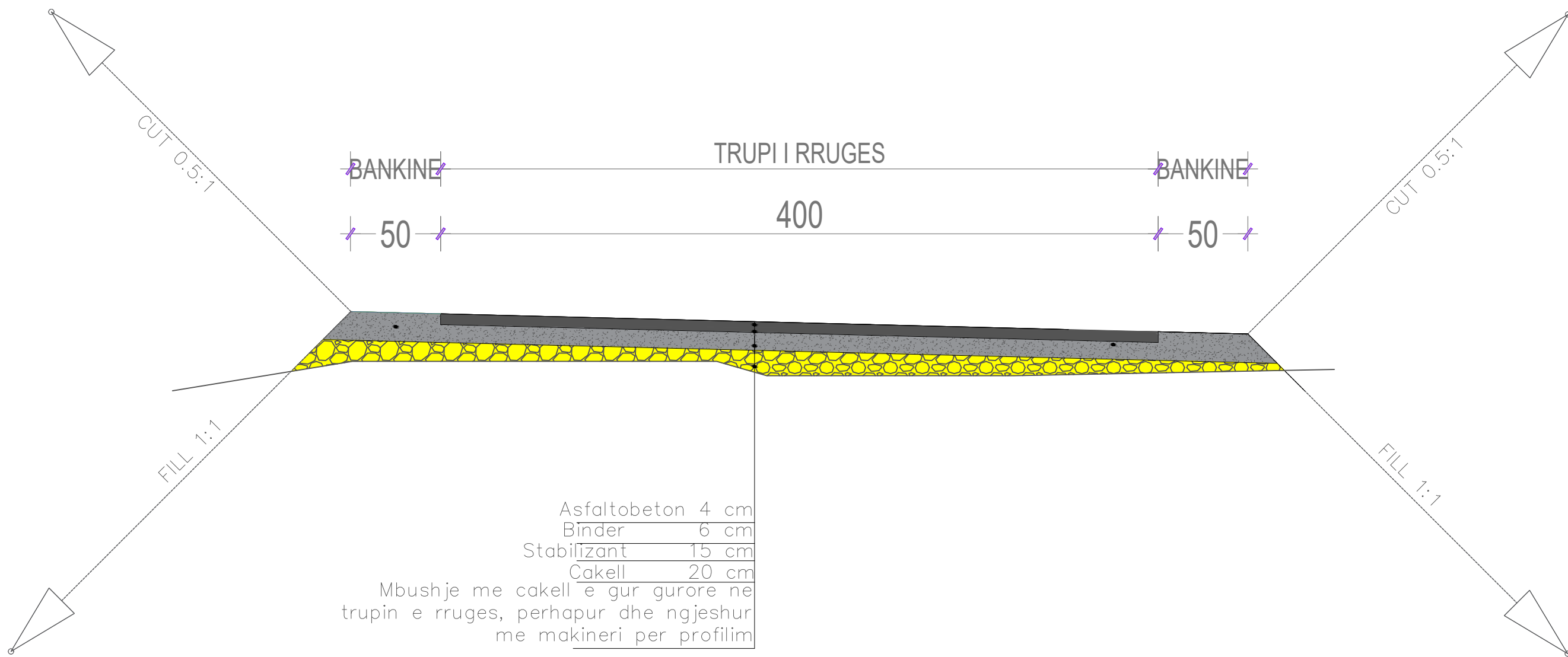

Porositi :
BASHKIA
MALESI E
MADHE

Projektoi:
"LENI-ING" sh.p.k
Liçense: N.2969

Adresa: Rr. Uran Pano, Pallati 12 kat, Kati 2
Mobile: 0682042270
Email: leni-ing@hotmail.com

Objekti: Sistemim asfaltim rruga Syri I Gjonit		
Faza: Projekt – Zbatim		
Emërtimi i Fletës: PROFILI TERTHORE TIP 1	Shkalla: Sh 1:25	Tiranë 2023 PT

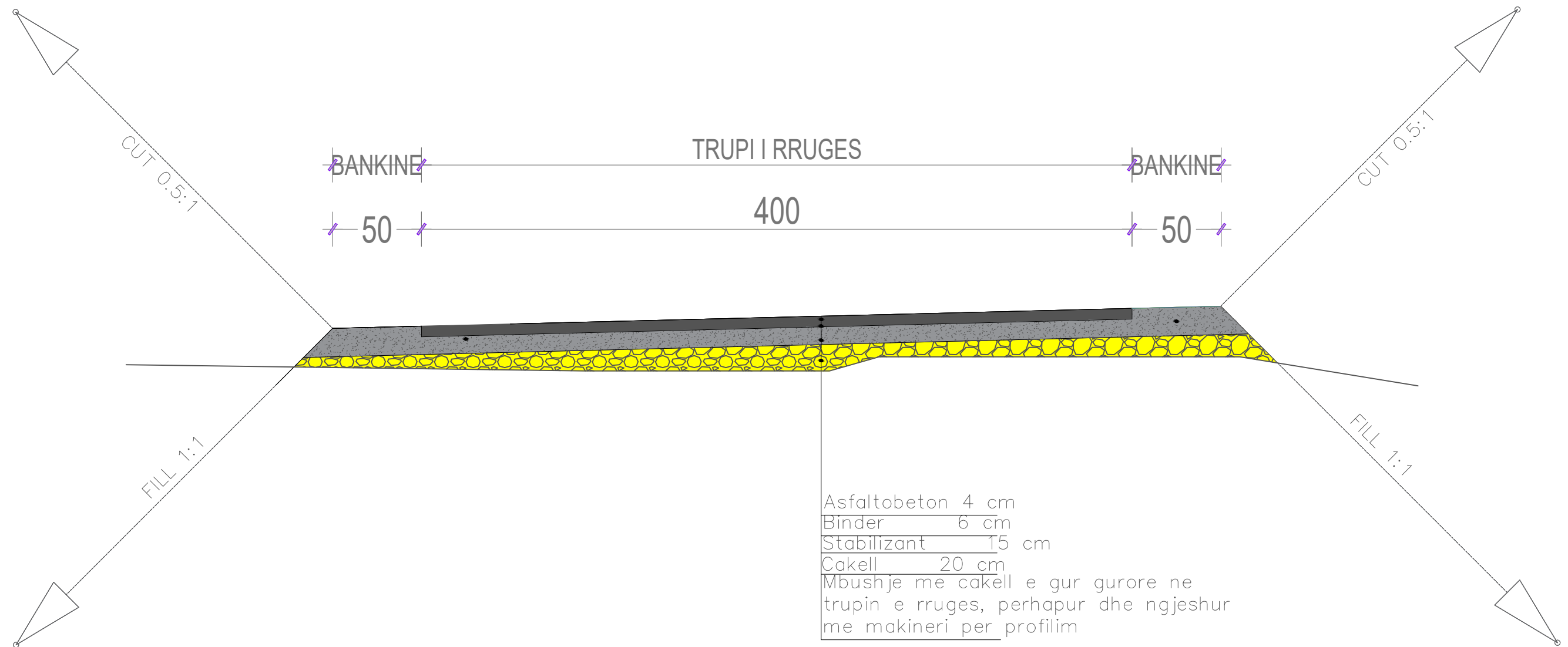

Porositi :
BASHKIA
MALESI E
MADHE

Projektoi:
"LENI-ING" sh.p.k
Liçense: N.2969

Adresa: Rr. Uran Pano, Pallati 12 kat, Kati 2
Mobile: 0682042270
Email: leni-ing@hotmail.com

Objekti: Sistemim asfaltim rruga Syri I Gjonit		
Faza: Projekt – Zbatim		
Emërtimi i Fletës: PROFILI TERTHORE TIP 2	Shkalla: Sh 1:25	Tiranë 2023 PT (1)

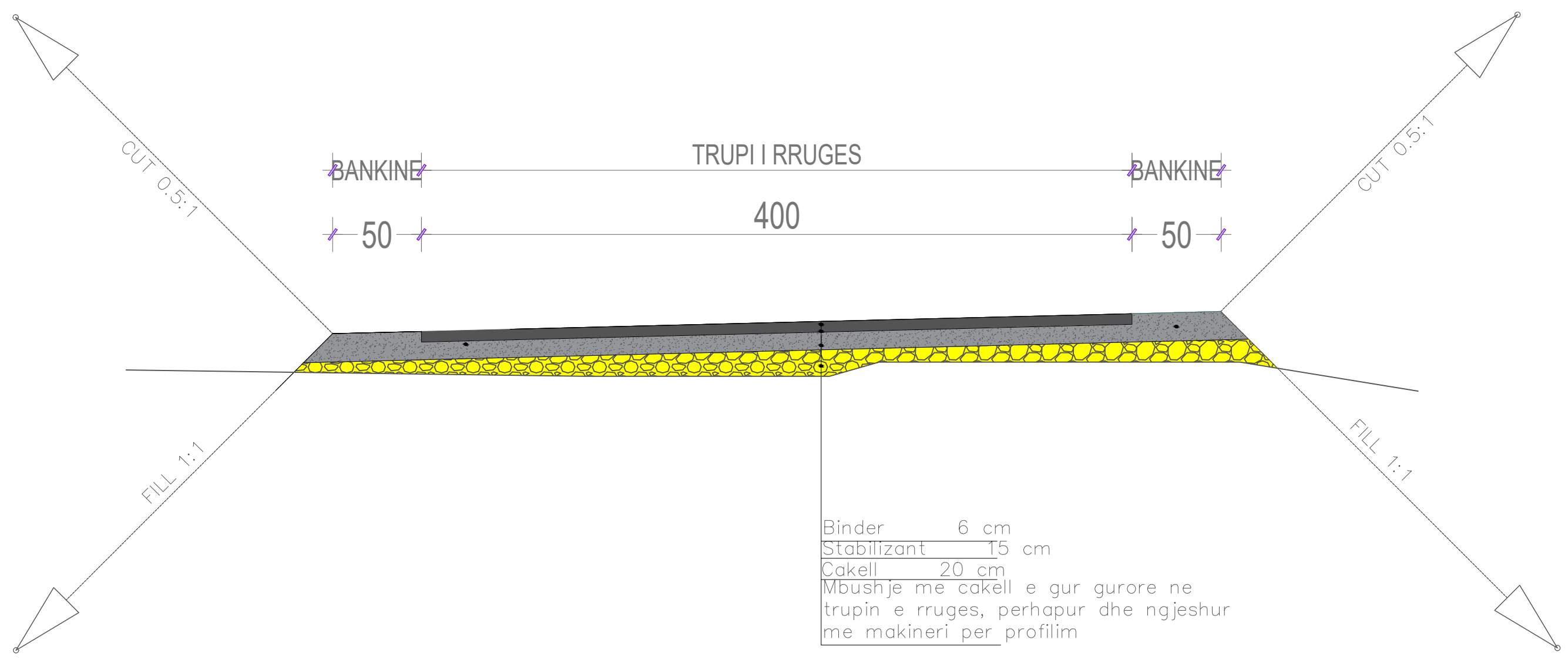

Binder 6 cm
 Stabilizant 15 cm
 Cakell 20 cm
 Mbushje me cakell e gur gurore ne trupin e rruges, perhapur dhe ngjeshur me makineri per profilim

Porositi : BASHKIA MALESI E MADHE	Projektoi: "LENI-ING" sh.p.k Liçense: N.2969 Adresa: Rr. Uran Pano, Pallati 12 kat, Kati 2 Mobile: 0682042270 Email: leni-ing@hotmail.com	Objekti: Sistemim asfaltim rruga Syri I Gjonit	
		Faza: Projekt – Zbatim	
		Emërtimi i Fletës: PROFILI TERTHORE TIP 3	Shkalla: Sh 1:25
		Tiranë 2023 PT (2)	

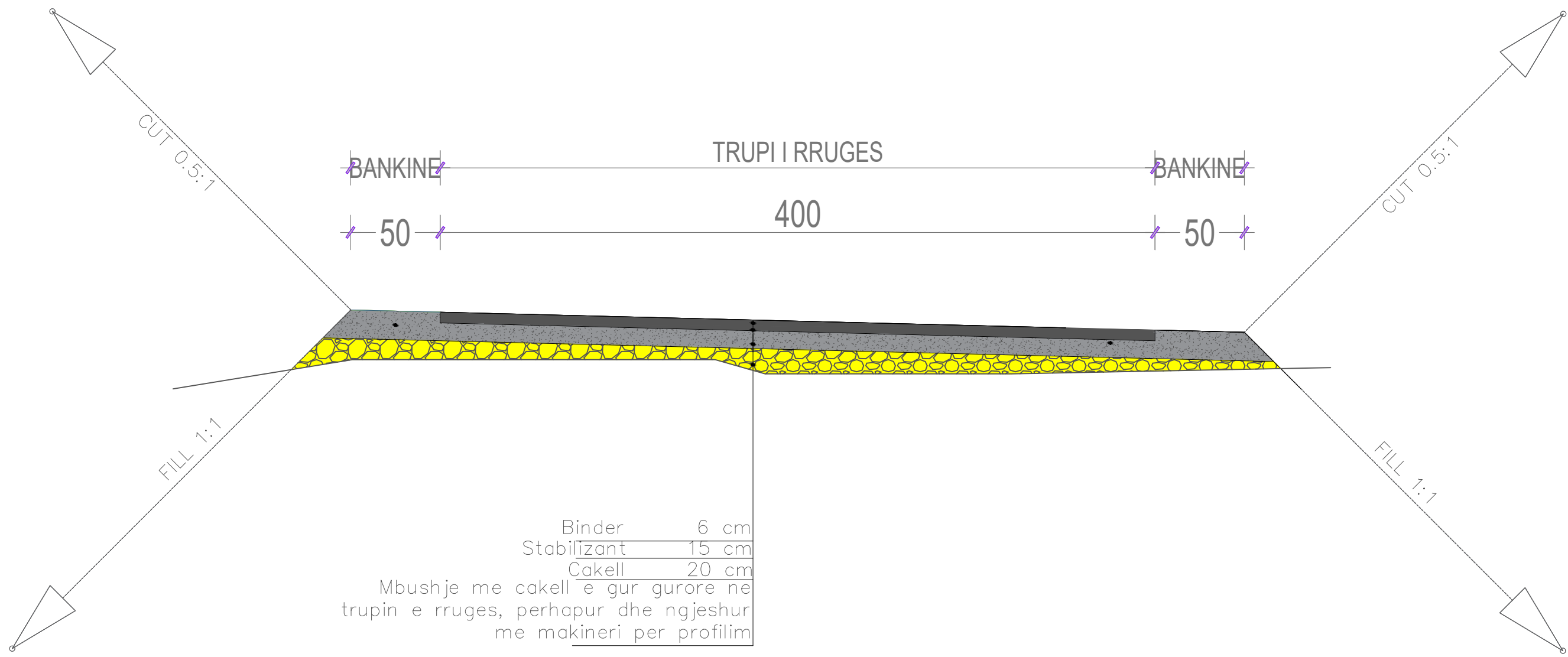

Binder	6 cm
Stabilizant	15 cm
Cakell	20 cm

Mbushje me cakell e gur gurore ne trupin e rruges, perhapur dhe ngjeshur me makineri per profilim

Porositi : BASHKIA MALESI E MADHE	Projektoi: "LENI-ING" sh.p.k Liçense: N.2969 Adresa: Rr. Uran Pano, Pallati 12 kat, Kati 2 Mobile: 0682042270 Email: leni-ing@hotmail.com	Objekti: Sistemim asfaltim rruga Syri I Gjonit	
		Faza: Projekt – Zbatim	
		Emërtimi i Fletës: PROFILI TERTHORE TIP 4	Shkalla: Sh 1:25